



A-12000

FRONT LIGHTS MOUNT KIT

(LIGHTS NOT INCLUDED -SOLD SEPARATELY)



This kit is for relocation or installation of (2) two 37.5 watt work lights (not included in this kit) onto John Deere Series One Tractors, model year 2011 and newer. On 1023E models, lights are not supplied with the tractor. If your tractor did not come with front work lights, the lights can be purchased from **Custom Products by ordering part number 3-19997**. On 1026R models, work lights are standard and are installed on the front side of the tractor fenders. Remove lights from fenders, if you have not already done so.

The two lights current draw should be 6.5 amps at 12 VDC. **Do not substitute higher wattage bulbs!**

Do not exceed the machine's available alternator capacity. If you do not know how much current is available, contact your dealer or manufacturer of this machine, prior to installing this kit.

Lights are to be mounted on the front of cab. This kit is for use with cab kit A-11976, which includes a main feed breaker and relay wire harness and 6-slot fuse block, already installed in the cab's overhead switch panel from the factory.

Before you begin, read these instructions and identify components. Please retain these instructions for future reference and parts ordering information.

05-11299
September 19, 2014

Kit Components:

ITEM	QTY	DESCRIPTION	PART NO.
1	2	FRONT LIGHT MOUNT BRACKET	1-48302
2	2	LIGHT MOUNT BRACKET	1-48343
3	4	BOLT, TRUSS BUTTON 5/16 x 3/4" LONG	3-19340
4	4	NUT, FLANGED, 5/16"	3-17111
5	1	ROCKER SWITCH, OFF-ON	3-18189
6	1	ROCKER SWITCH ACTUATOR, LIGHTS	3-18514
7	1	FUSE, 10 AMP	3-16057
8	4	NYLON TIE WITH 1/4" RETAINER TREE	3-19594
9	4	NYLON TIE	3-16629
10	2	BOLT, HEX HEAD, 5/16 x 2" LONG	3-10012
11	4	NUT, CENTERLOCK, 5/16"	3-12913
12	2	BOLT, HEX HEAD, 5/16 x 5/8" LONG	3-10007
13	1	WIRE HARNESS, FUSE BLOCK TO SWITCH	3-19686
14	1	WIRE HARNESS, LIGHTS	3-19322

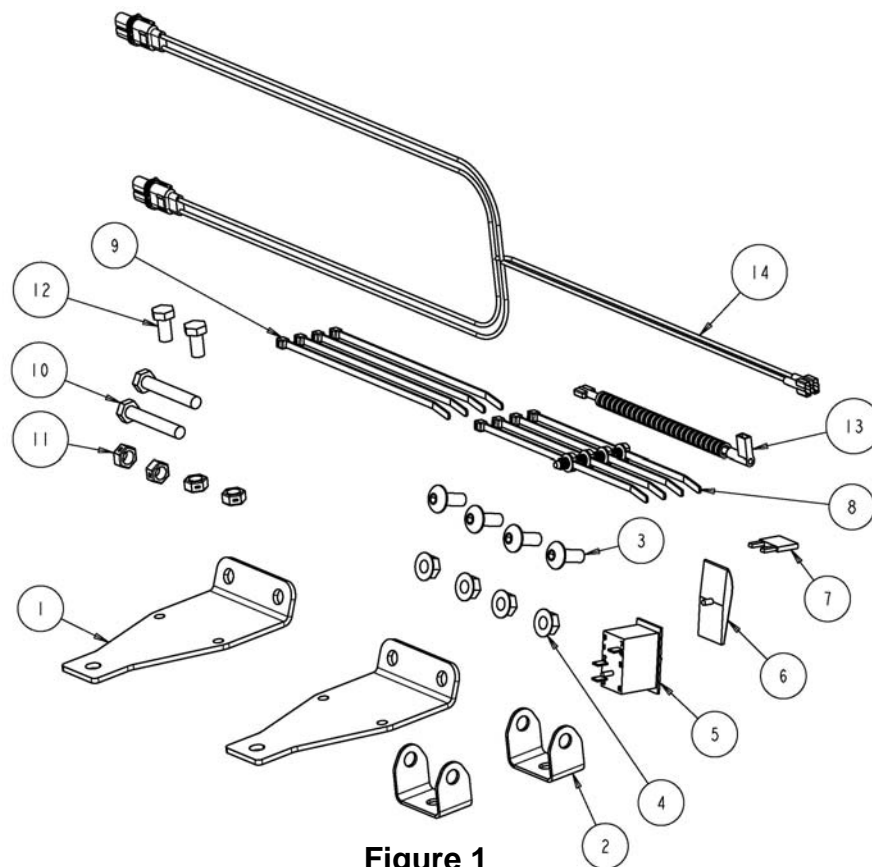

Figure 1

Installation Steps:

1. Remove the 5/16" bolts that secure the overhead switch panel to the cab frame header area.
2. Remove front roof bolts and place a block to gap the roof 2-3" above the front cross member.
3. Secure light mount bracket (Item 2) to front mount bracket (Item 1) using 5/16 x 5/8" long bolt (Item 12) and a 5/16" center lock nut (Item 11) (**Figure 2**).
4. Secure light to light mount bracket (Item 2) using (2) 5/16 x 2" hex head bolts (Item 10) and a 5/16" center lock nut (Item 11) (**Figure 2**).
5. If mirrors are present, remove mirror bracket mounting bolts (**Figure 3**).

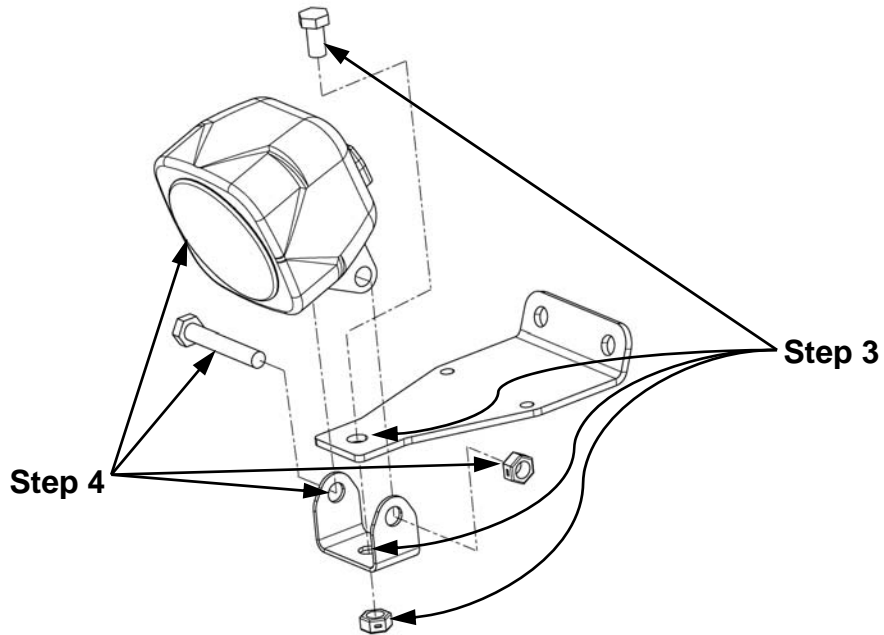

Figure 2

6. Secure each front light mount bracket to cab cross member (If mirrors are present, secure each light with mirror brackets using the bolts and holes) using **(Figure 3)**;
 - (2) 5/16 x 3/4" long button truss bolts (Item 3)
 - (2) 5/16" flange nuts (Item 4)

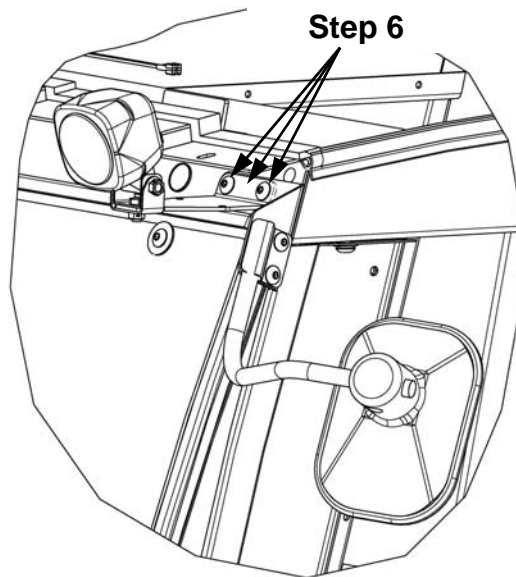

Figure 3

7. Locate wire harness with light connector ends (Item 14). Connect light end of wire harness to each light **(Figure 4)**.
8. Route opposite end of wire harness, to switch panel area, between roof and header cross member.
9. Select an empty location on switch panel to install rocker switch (Item 5). Remove rectangular knockout **(Figure 4)**.
10. Run switch end of wire harness through switch knockout. Connect switch end of wire harness to rocker switch terminal 3. Refer to labels on harness **(Figure 5)** for correct wire connections.
11. Remove fuse block access cover from headliner and select an empty fuse terminal location.
12. Locate the shorter single wire fuse block to switch wire harness 3-19686 (Item 13). Connect 90 degree end of wire to empty fuse terminal location, selected in step 11 **(Figures 4 & 6)**.

13. Connect opposite end of wire through switch knockout hole and connect to rocker switch terminal 2 (**Figure 5**).
14. Connect **black** wire of harness labeled -12VDC Lights to ground terminal of fuse block (**Figures 4 & 6**).
15. Attach switch actuator (Item 6) to rocker switch (Item 5) then install switch into knockout (**Figure 4**).
16. Install 10 amp fuse into fuse block location selected in Steps 11-12 (**Figures 4 & 6**).
17. Remove block and lower roof. Re-secure front of roof.

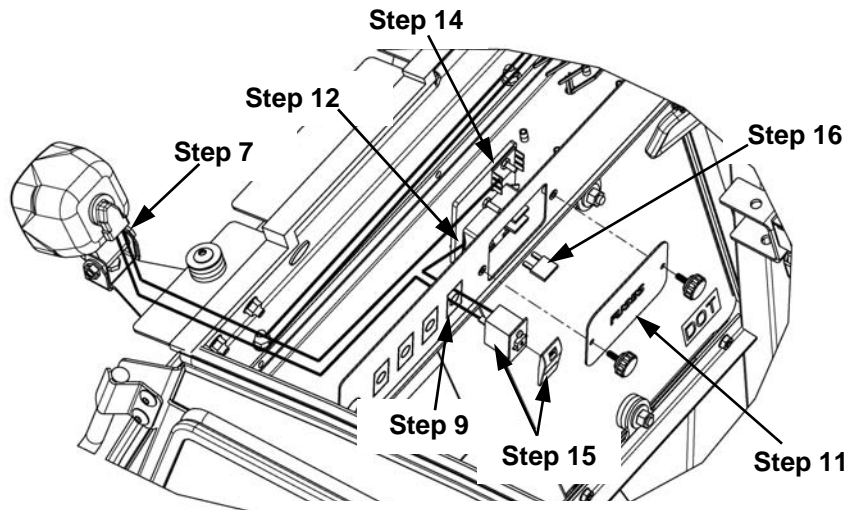

Figure 4
(Roof not shown)

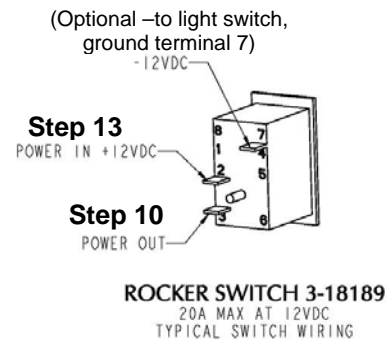

Figure 5

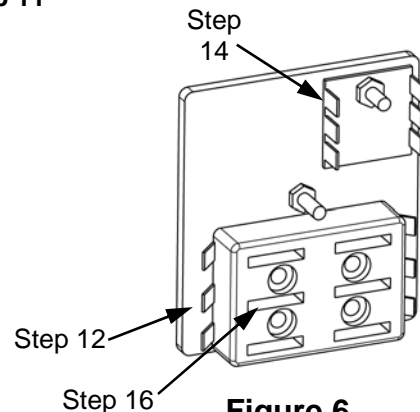

Figure 6
(Fuse block)

Completing installation:

18. Turn tractor's ignition key to "On".
19. Turn lights on and off to check proper operation. Check coverage area and adjust lights if needed.
20. Secure wire harnesses using nylon ties and ties with tree retainers for ¼" holes.
21. Secure switch panel to cab frame and fuse block access cover to switch panel.

Manufactured by:
 **CUSTOM PRODUCTS**
 OF LITCHFIELD, INC.
 BOX 70 • LITCHFIELD, MINNESOTA 55355-0070
 (320) 693-3221 Fax: (320) 693-7252
www.cpcabs.com

05-11299
 September 19, 2014