

# A-11998

## INTERIOR MIRROR KIT

Before you begin, read these instructions and check to be sure all parts and tools are accounted for. Please retain these instructions for future reference and parts ordering information (**Figure 1**).

Kit Components:	ITEM	QTY	DESCRIPTION	PART NO.
	1	1	MIRROR HEAD, STUD MOUNT	3-19713
	2	2	FLANGE NUT, 8mm	3-16836

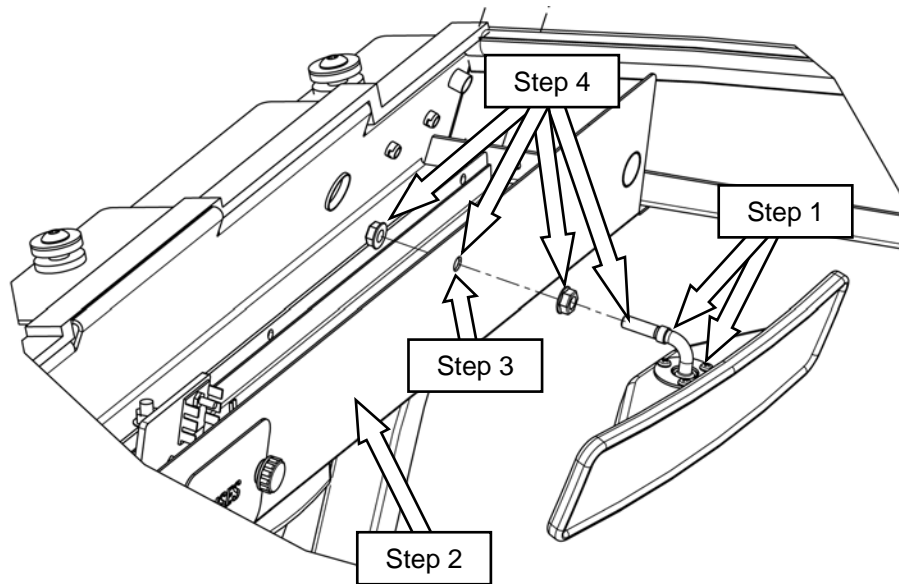

**Figure 1**

**Installation Tools:** Standard wrench set and Philips screwdriver.

**IMPORTANT:** Perform all steps correctly and completely.

### **Interior Mirror Installation (See Figure 1);**

1. Remove mirror assembly from box and loosen Philips screws, enough so that the mount arm can move with some tension. Tighten screws if arm becomes too loose.
2. Remove the bolts that secure the overhead switch panel and allow panel to tip down.
3. Remove one 3/8" hole plug located on the right side of overhead switch panel.
4. Secure mirror (1) to overhead switch panel using (2) 8mm flange nuts (one on each side of panel).
5. Re-secure switch panel to cab.

 **CUSTOM PRODUCTS** ©2012  
OF LITCHFIELD, INC.  
PO BOX 70, 1715 S. Sibley Avenue, Litchfield, MN 55355-0070  
Ph: (320) 693-3221 Fax: (320) 693-7252  
www.800cabline.com

05-11305  
April 28, 2014