

INSTALLATION INSTRUCTIONS
John Deere One Series; 1023E, 1025R and 1026R Models



A-11978 HEATER KIT

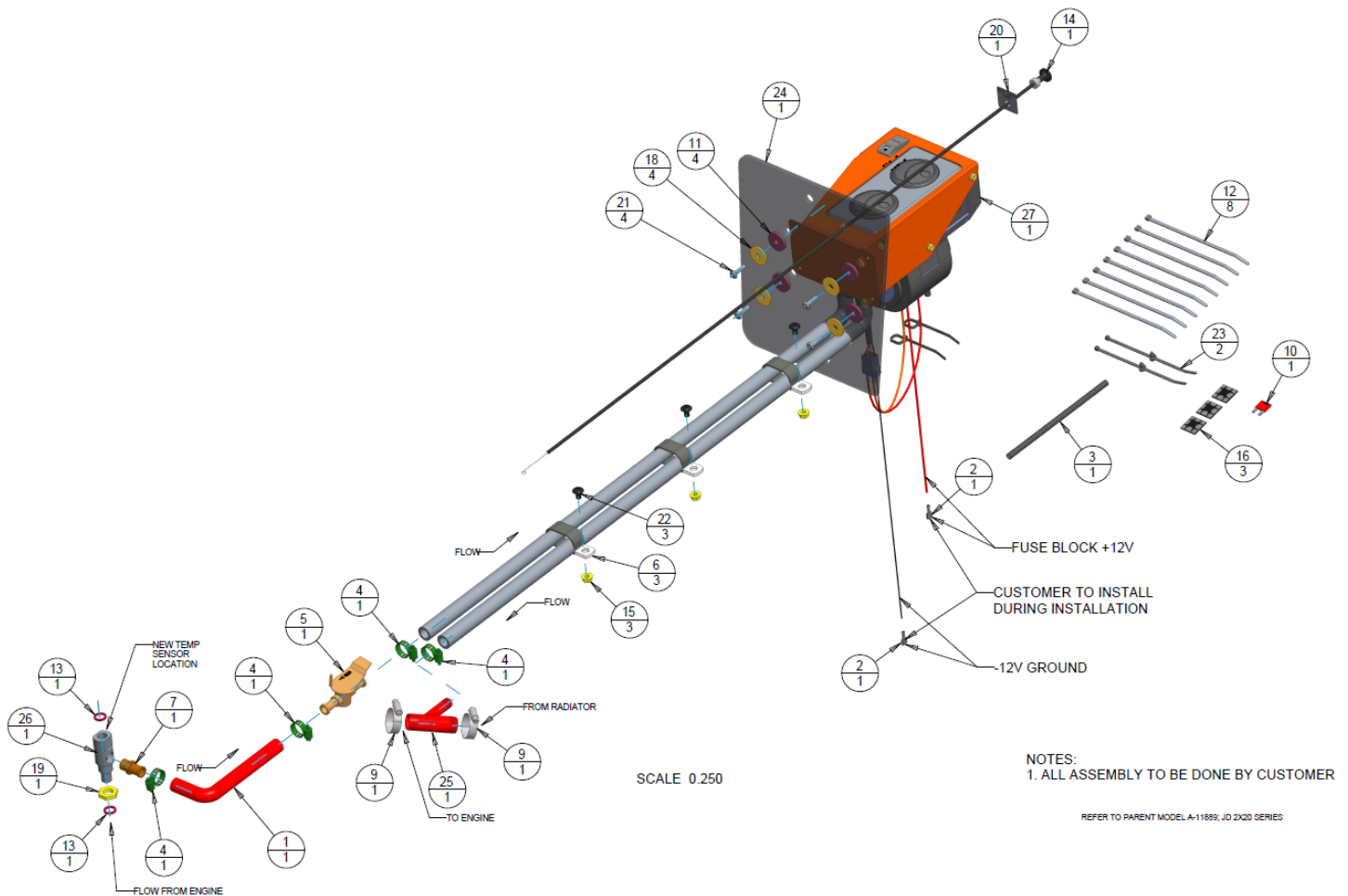

Figure 1
(General Layout and Parts I.D.)

Read these instructions and identify all components. Please retain these instructions for future reference and parts ordering information. Refer to kit components and Figure 1 for general layout.

INSTALLATION INSTRUCTIONS
John Deere One Series; 1023E, 1025R and 1026R Models

Kit Components:

ITEM	CP NUMBER	QTY	UOM	DESCRIPTION	SECOND DESCRIPTION
1	1-49570	1	EA	HOSE, ELBOW 90	MODIFIED 3-11861
2	3-10670	2	EA	TERMINAL, 14-16 GA, .250 BLADE	FEMALE, FULLY INSULATED
3	3-10704	1	EA	WIRE DUCT, .350 ID X .51 OD	BLACK LOOM 76" LG
4	3-10858	4	EA	CLAMP, HOSE, #10, .562-1.062	H10
5	3-11220	1	EA	VALVE, HEATER, TEMP CONTROL,	CABLE OPERATED, PULL TO OPEN
6	3-11255	3	EA	CLAMP, HEATER HOSE, DOUBLE	
7	3-12119	1	EA	FITTING, .375 NPT TO .625 HOSE	1.56 LONG BRASS
8	3-12683	1	EA	BOX, 18.00 X 12.00 X 7.00	200 LB
9	3-13442	2	EA	CLAMP, HOSE, #16, .625-1.500	H16
10	3-16057	1	EA	FUSE, ATOATC, 10 AMP, RED	AUTOMOTIVE BLADE TYPE
11	3-16217	4	EA	WASHER, SHOULDER, GLASS MOUNT	1.250 DIA X .313, BLACK EPDM
12	3-16629	8	EA	WIRE TIE, NYLON, BLACK, 7.50L	
13	3-16823	2	EA	O-RING, DOUBLE SEAL, BUNA-N	3/32 X .563 ID X .750 OD
14	3-17100	1	EA	CABLE, PUSH-PULL, 48" LONG	TEMP CONTROL, W/KNOB
15	3-17111	3	EA	NUT, HEX, .312-18 NC SER FLNG	COATED BLACK PER RIE4900/4037A
16	3-17517	3	EA	WIRE TIE MOUNT, BLACK NYLON	1.12 X 1.12, PSA BACK VHB ADHV
17	3-17839	1	EA	PAINT, BLACK SEMI 45	2 OZ
18	3-18187	4	EA	WASHER, FENDER, .344 ID X 1.25	COATED BLACK PER RIE4900/4037A
19	3-18259	1	EA	NUT, HEX, JAM, M16 X 1.50	COATED BLACK PER RIE4900/4037A
20	3-18819	1	EA	DECAL, PULL FOR HEAT	
21	3-19335	4	EA	MSCR, .25-20 NC X 1.00 TH TORX	COATED BLACK PER RIE4900/4037A
22	3-19338	3	EA	MSCR, .312-18 NC X .50 TH TRX	COATED BLACK PER RIE4900/4037A
23	3-19594	2	EA	WIRE TIE, NYLON WITH RETAINER	FIR TREE TYPE FOR 1/4" HOLE
24	3-19998	1	EA	*R150 X .220 X 38.82W X 29.14H	.220 X 12.852 X 14.321
25	3-20137	1	EA	FITTING, Y, HOSE, 1.125 THRU	X .625 AT 40 DEG, BLACK
26	3-20284	1	EA	FITTING, ALUMINUM, JAM TYPE	M16M X 3/8 NPT F X M16F
27	4-15815	1	EA	HEATER ASSEMBLY	JD CABS
28	05-11312	1	EA	LABEL, BOX	
29	05-11313	1	EA	MOUNTING INSTRUCTIONS	FOR A-11978

Note: Cab kit A-11858 must be installed prior to installing this kit!

Preparation of Tractor;

1. Park tractor on level surface and turn ignition key off.
2. Allow engine to cool. Drain coolant from radiator. Open hood and remove engine side panel covers.

Mounting the heater unit;

3. Remove lower RH front window from cab (**Figure 2A**) and remove seals from window.
4. Install seals onto new window supplied with heater kit (**Figure 3**).
5. Re-install window with seals onto lower RH front cab location (**Figure 3**) re-using window hardware.
6. Secure the heater unit onto the inside surface of the new window using (**Figures 2B and 3**);
 - (4) 1/4" x 1" button socket head bolts
 - (4) 5/16" flat fender washers
 - (4) Rubber shoulder washers

INSTALLATION INSTRUCTIONS
John Deere One Series; 1023E, 1025R and 1026R Models

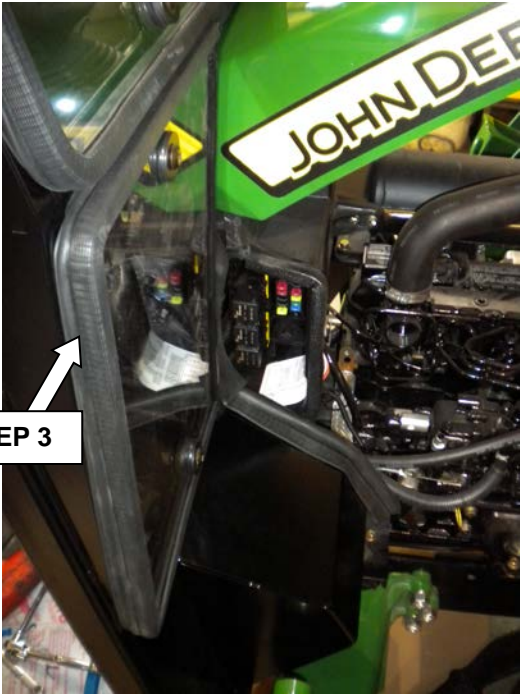

Figure 2A

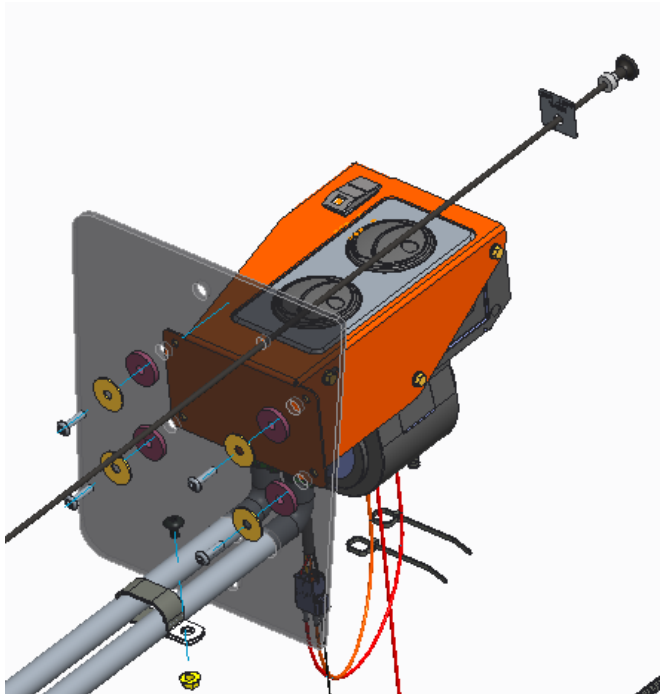

Figure 2B

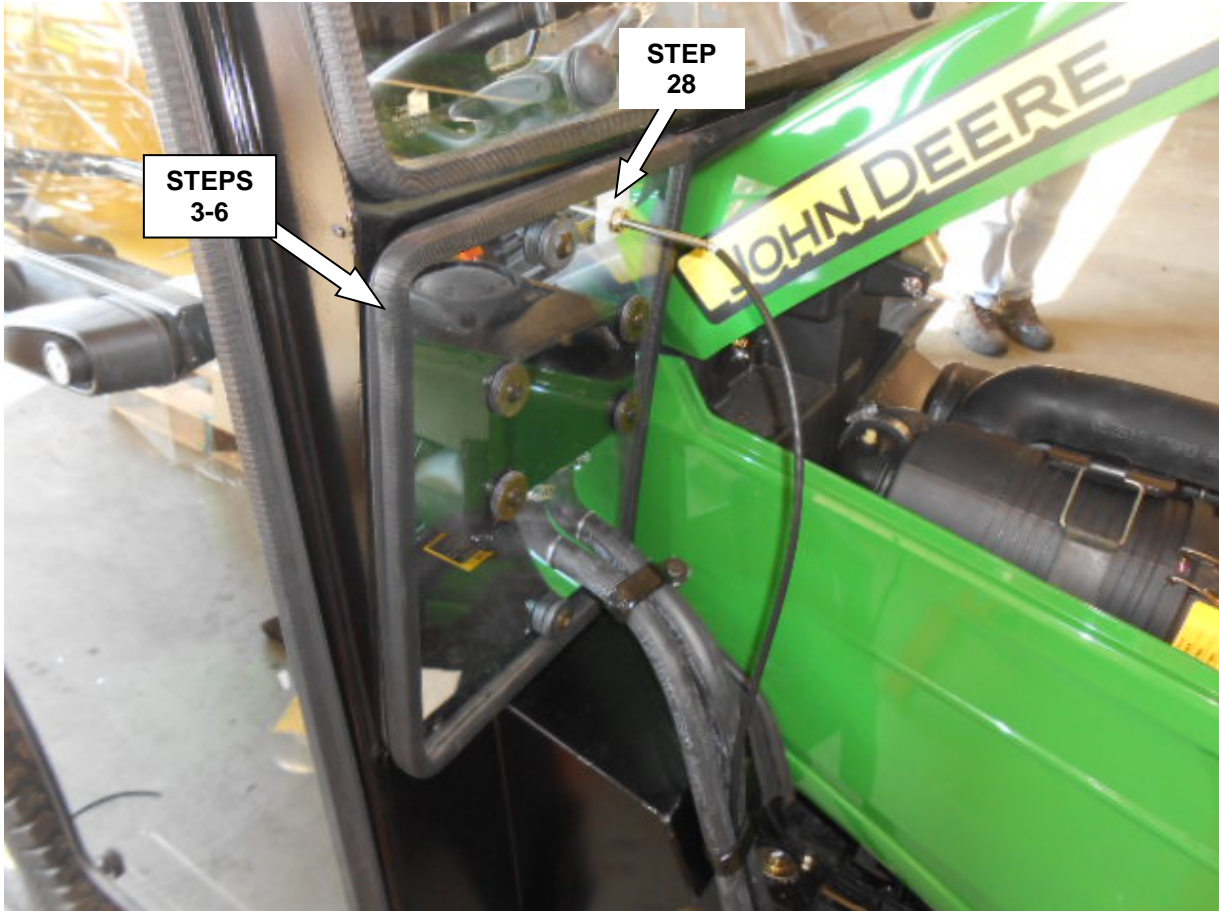

Figure 3

INSTALLATION INSTRUCTIONS
John Deere One Series; 1023E, 1025R and 1026R Models

Supply connection from engine to heater unit (Steps 7-17) (Figures 4A & 4B);

7. Locate temperature sensor near thermostat area. Remove temperature sensor with brass washer.
8. Thread M16 jam nut onto aluminum fitting to the fitting shoulder (**Figure 4A**).
9. Thread 4-way O-ring washer onto m16 male thread on aluminum fitting.
10. Install aluminum fitting with O-ring and nut, into engine port location until O-ring makes contact (**Figure 4B**). Thread tape may be used.
11. Orientate fitting so that the brass fitting for the heater hose can be easily installed (Figure 4B).
12. Using the M16 jam nut, unscrew the nut until the jam nut makes contact with the O-ring and becomes tight, preventing the aluminum fitting from rotating (**Figures 4B**).
13. Reinstall temperature sensor into aluminum fitting along with remaining O-ring.
14. Install brass fitting into aluminum fitting using thread sealing tape.
15. Connect 5/8" x 17.00" long, heater hose elbow to brass fitting and secure using a small hose clamp.
16. Connect shut-off valve to remaining end of 5/8" x 17" long heater hose and secure using a small hose clamp. **Note: The valve must be install and oriented as shown in Figure 4A.**
17. Connect 5/8" x 38.00" long heater hose from heater to remaining end of shut-off valve and secure using a small hose clamp.

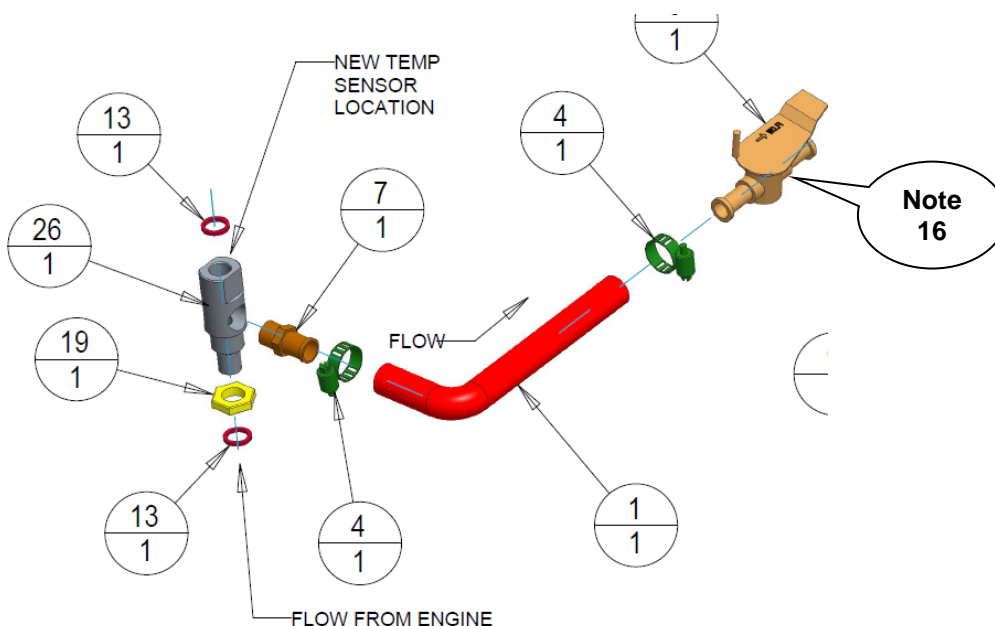

Figure 4A



Figure 4B

INSTALLATION INSTRUCTIONS
John Deere One Series; 1023E, 1025R and 1026R Models

Return connection from heater unit to engine (Steps 18-20) (Figure 5A & 5B);

18. Locate lower radiator hose. Cut hose and install the reducing Y-fitting as shown in **Figure 5**.

19. Secure using large hose clamps.

20. Connect 5/8" x 38" long, heater hose from heater to 5/8" nipple on Y-fitting and secure using small hose clamp.

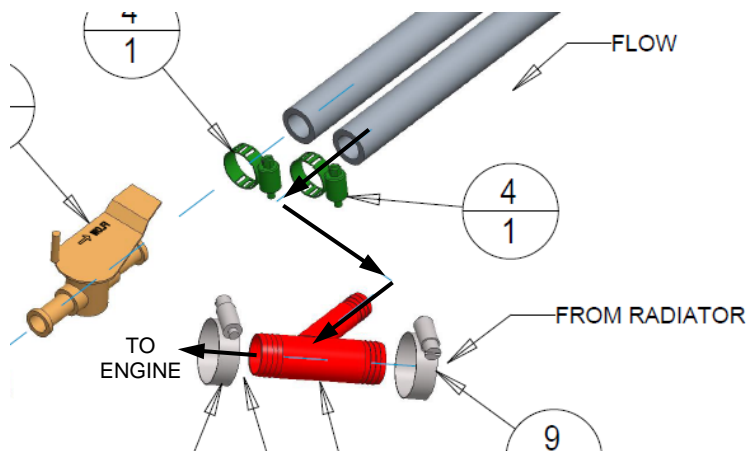

Figure 5A



Figure 5B

Connecting power to headliner;

21. Remove (4) headliner bolts and lower headliner.

22. Select an empty fuse block location.

23. Route red wire up to fuse block location. Trim excess wire. Attach a .25" female spade terminal connector to end of red wire using a wire crimping tool. Connect to fuse block location.

24. Route black wire to fuse block grounding terminals. Trim excess wire. Attach a .25" female spade terminal connector to the end of black wire using a wire crimping tool. Connect to -12vdc ground bar.

25. Install 10 amp fuse into fuse location.

26. Cover wires with split loom conduit and secure wires with wire ties and wire tie mounts.

27. Reinstall headliner and bolts.

Completing Installation;

28. Apply push/pull decal to inside of RH front window (**Figure 3**).

29. Install push/pull cable (2) from inside of RH front window. Route loop end of cable to shut-off valve (**Figure 6**). Secure to window with hardware supplied with push/pull cable.

30. Connect loop end of push/pull cable to shut-off valve and secure cable using hardware supplied with valve (**Figure 6**).

31. Refill radiator.

32. Start tractor and turn heater switch on and off to check blower operation.

33. Pull and push cable several times to activate valve and allow coolant to circulate through the heater.

34. Shut engine off and check coolant. This may take several attempts to purge all the air from the system.

INSTALLATION INSTRUCTIONS
John Deere One Series; 1023E, 1025R and 1026R Models

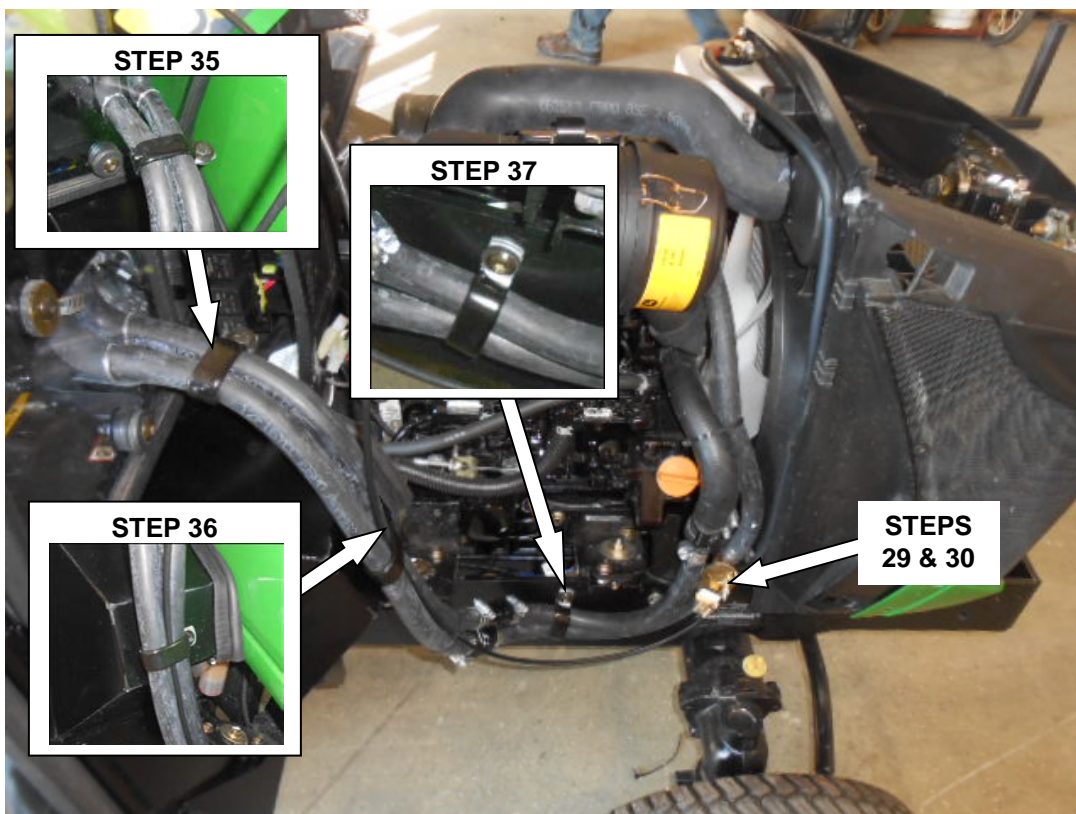

Figure 6

35. Measure 4 inches from front window and secure heater hoses together using (**Figure 6**);
 - (1) Double P-clamp
 - (1) ¼" x 1.00" long bolt
 - (1) ¼" hex flange nut
36. Secure heater hoses and push/pull cable to front of RH pedal pocket. A ¼" hole will need to be drilled into the pedal pocket panel as shown in (**Figure 6**), if hole is not present. Secure using;
 - (1) Double P-clamp
 - (1) ¼" x 1.00" long bolt
 - (1) ¼" hex flange nut
37. Secure heater hoses to frame location as shown in (**Figure 6**). Use existing hole already in the frame. Secure to frame using;
 - (1) Double P-clamp
 - (1) ¼" x 1.00" long bolt
 - (1) ¼" hex flange nut

Finishing Installation;

38. Secure loose wires and hoses using nylon ties supplied with kit. ***Do not*** secure wires or hoses to high pressure fuel lines, hot surfaces or moving components.

Revised 09-27-13; 1025R addition; cad
Revised 11-10-15; Changed aluminum fitting to jam type; added jam nut and one additional O-ring washer; cad
Revised 01-18-17; Added O-ring to step 13; cad
Revised 02-27-17; Replaced Red Dot heater unit with Aurora brand

Installation is now complete. If you have any questions or comments, contact;

 **CUSTOM PRODUCTS** ©2017
OF LITCHFIELD, INC.
PO BOX 70, 1715 S. Sibley Avenue, Litchfield, MN 55355-0070
Ph: (320) 693-3221 Fax: (320) 693-4833
www.cpcabs.com

ITEM	CP NUMBER	QTY	UOM	DESCRIPTION	SECOND DESCRIPTION
1	1-46940	2	EA	HOSE, FORMED, 39.50	MODIFIED 3-11861
2	2-16949	1	EA	WELDMNT, HEATER BRACKET	AURORA
3	3-10345	1	EA	WIRE, BLACK, 14 GA GPT X 108"	STRANDED
4	3-10364	1	EA	WIRE, RED 14 GPT	X 24.00" LONG
5	3-10364	1	EA	WIRE, RED, 14 GA, GPT	4.00" STRANDED
6	3-10364	1	EA	WIRE, RED, 14 GA, GPT	X 120.00" LONG
7	3-10670	7	EA	TERMINAL, 14-16 GA, .250 BLADE	FEMALE, FULLY INSULATED
8	3-10704	1	EA	WIRE DUCT, .350 ID X .51 OD	BLACK FLEXIBLE LOOM
9	3-10858	2	EA	CLAMP, HOSE, #10, .562-1.062	H10
10	3-14011	1	EA	WIRE, ORANGE 14 GA GPT	X 24.00" LONG
11	3-16074	1	EA	TERMINAL, 14-16 GA, .250 BLADE	MALE, FULLY INSULATED
12	3-16629	2	EA	WIRE TIE, NYLON, BLACK, 7.50L	
13	3-18190	1	EA	SWITCH, ROCKER BODY NO LITE	OFF-ON-ON, 44327 SPTT
14	3-18253	1	EA	TERMINAL, T-TAP, 14-18 GA	BLUE
15	3-18511	1	EA	ACTUATOR, ROCKER SWITCH	WHITE LENS WITH FAN IMPRINT
16	3-22497	3	EA	SHEET METAL SCREW SELF DRILL	#10-16 X 1/2 HEX WITH WASHER
17	3-22872	1	EA	HEATER UNIT, 12 V, W/LOUVERS	3 SPD, 14.6 K BTU, 5 AMP

REV	DCR #	DESCRIPTION	DATE	CHG BY
A	12729	HEATER 3-22872 WAS 3-18067	02-23-17	CAD
B	12872	MSCR 3-22497 WAS 3-12057	08-07-17	CAD

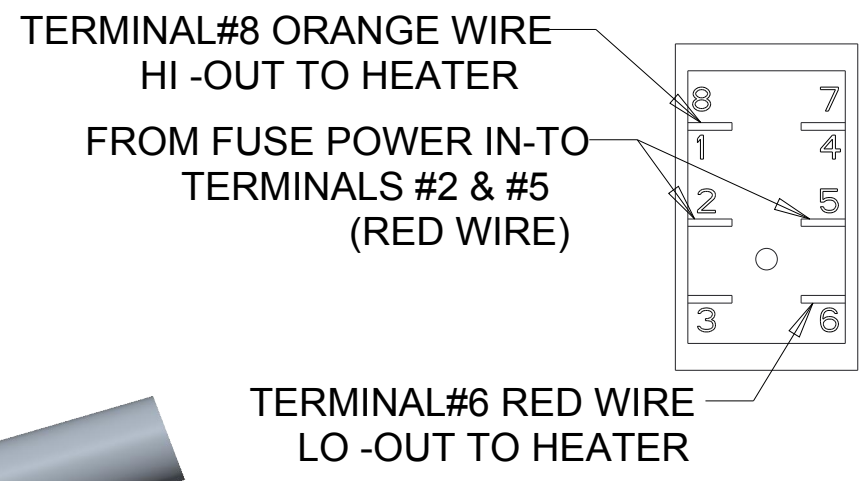
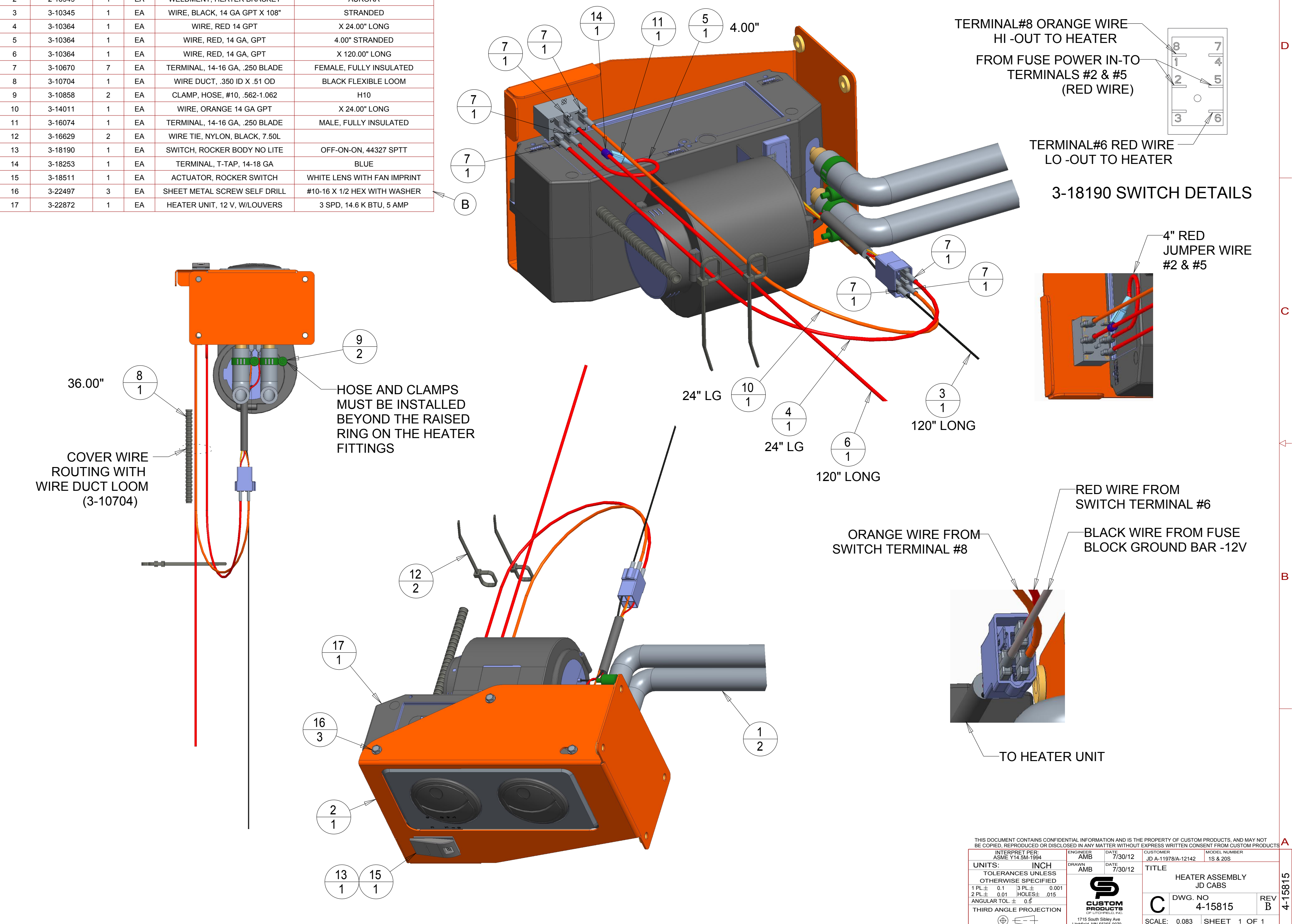

3-18190 SWITCH DETAILS

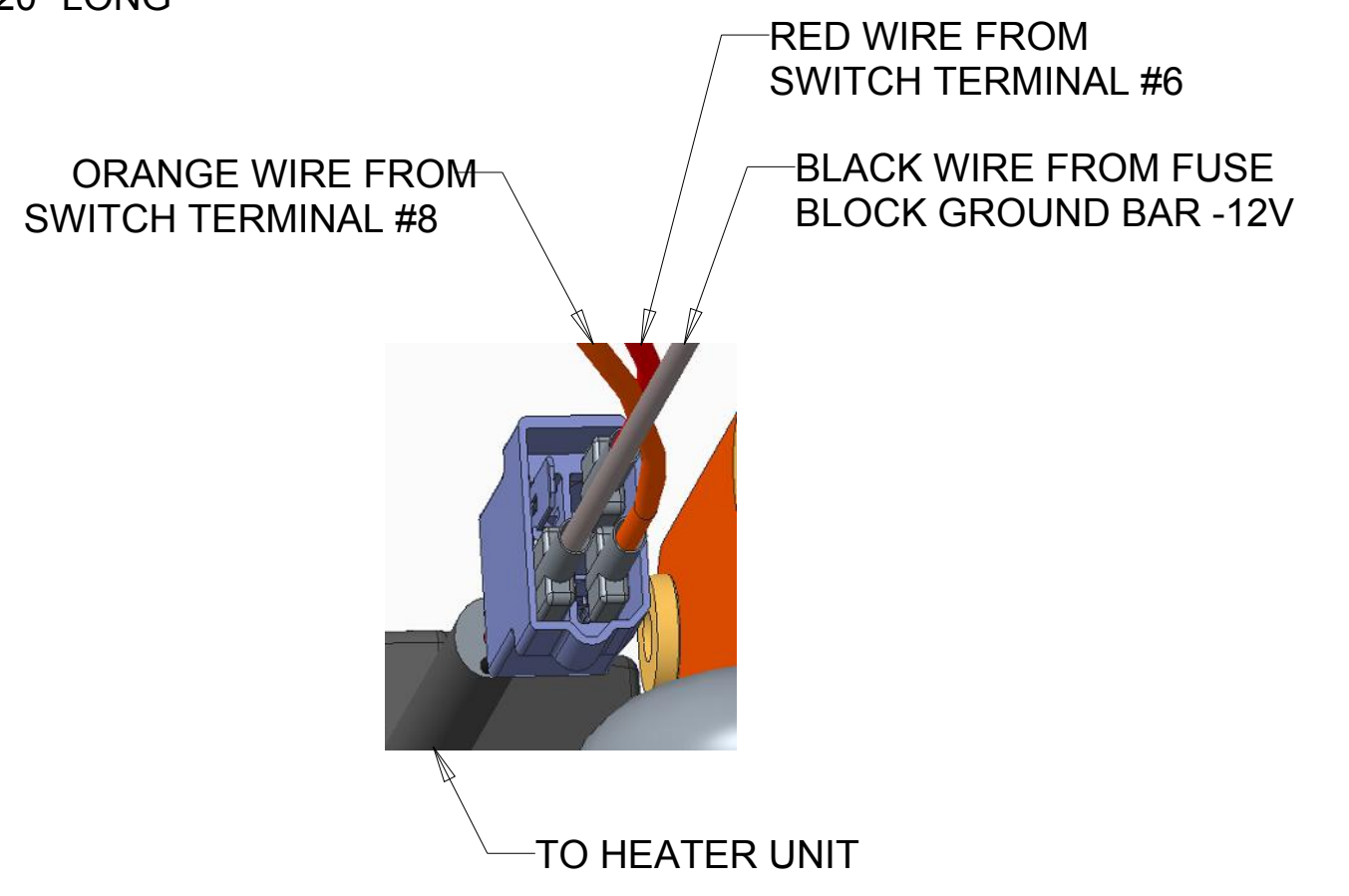
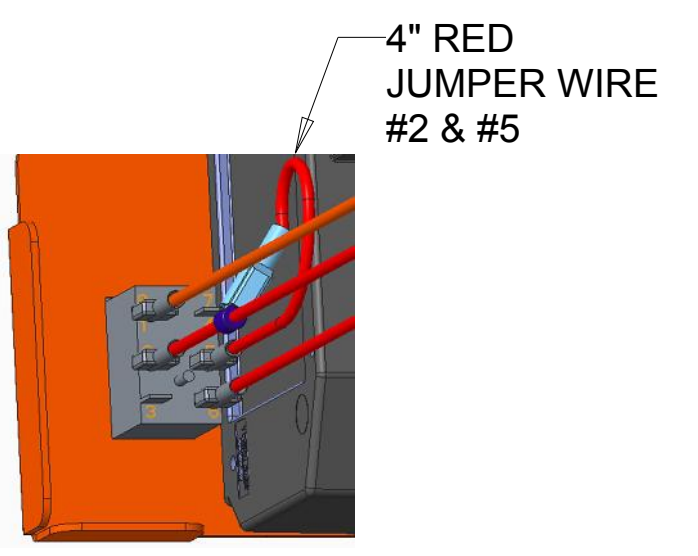

THIS DOCUMENT CONTAINS CONFIDENTIAL INFORMATION AND IS THE PROPERTY OF CUSTOM PRODUCTS, AND MAY NOT BE COPIED, REPRODUCED OR DISCLOSED IN ANY MANNER WITHOUT EXPRESS WRITTEN CONSENT FROM CUSTOM PRODUCTS.

INTERPRET PER: ASME Y14.5M-1994	ENGINEER AMB	DATE 7/30/12	CUSTOMER JD A-11978/A-12142	MODEL NUMBER 1S & 20S
UNITS: 1 INCH TOLERANCES UNLESS OTHERWISE SPECIFIED 1 PL ± 0.1 2 PL ± 0.01 3 PL ± 0.001 HOLES ± 0.015 ANGULAR TOL ± 0.5	DRAWN AMB	DATE 7/30/12	TITLE HEATER ASSEMBLY JD CABS	REV B
THIRD ANGLE PROJECTION			SCALE: 0.083	SHEET 1 OF 1

CUSTOM PRODUCTS
OF OHIO, INC.
1715 South Sibley Ave
Litchfield, MN 55355-0070

4-15815