



A-11821
EZ CAB FRAME fits
McCormick CT Models and
Landini 2840, 3640, 4140 & 4740 Models
(Shown with optional A-11691 EZ HARD DOORS KIT)

- A-11692 VINYL SOFT DOORS KIT
- A-11691 HARD DOORS WITH NON-SLIDER WINDOWS KIT
- A-11638 CAB HEADLINER KIT W/ FUSE BLOCK, DOME LIGHT AND WIRE HARNESSSES
- A-11639 WIPER KIT, RADIAL COVERAGE, 12VDC
- A-11640 WIPER KIT, RADIAL COVERAGE, MANUALLY OPERATED
- A-11641 LIGHTS KIT, FRONT MOUNTED, RH AND LH, 12VDC
- A-11642 HEADLINER VENTILATION FAN KIT, 2 FANS
- A-11643 EXTERIOR MIRROR KIT, RH AND LH
- A-11644 HEATER KIT, 12VDC, 15,000 BTU
- A-11645 SLIDER WINDOWS FOR DOORS KIT A-11637 OR A-11691
- A-11646 WARNING AMBER STROBE LIGHT, 12VDC
- A-11647 JENSEN HD RADIO AND SPEAKERS KIT
- A-11648 STANDARD 7" FAN KIT, 12VDC

Manufactured by:



BOX 70 • LITCHFIELD, MINNESOTA 55355-0070
(320) 693-3221 Fax: (320) 693-7252
www.800cabline.com

CAB FRAME MOUNTING INSTRUCTIONS

Before you begin, read these instructions and check to be sure all parts and tools are accounted for. Please retain these instructions for future reference and parts ordering information.

Kit Components:

ITEM	QTY	PART NO.	DESCRIPTION
1	1	4-15379	FRONT WINDOW, UPPER AND LOWER HOOD SEAL ASSEMBLIES
2	1	2-16483	LH SIDE FRAME
3	1	2-16484	RH SIDE FRAME
4	1	4-15380	REAR WINDOW ASSEMBLY
5	1	4-15324	ROOF ASSEMBLY
6	1	4-15381	MOUNT KIT CONSISTS OF;
7	3	3-10393	3/8 x .75" LONG, HEX HEAD BOLTS
8	3	3-17622	3/8" FLANGE NUT
9	6	3-18797	5/16 x 2.50" LONG, BUTTON HEAD BOLT
10	16	3-18796	5/16 x 2.00" LONG, BUTTON HEAD BOLTS
11	28	3-17111	5/16" FLANGE NUT
12	19	3-18503	5/16 x .75" LONG, BUTTON HEAD BOLTS
13	15	3-10085	5/16" FLAT WASHER
14	1	2-16495	REAR MOUNT FOR "I" MODELS, 28 AND 36 Series
15	1	2-16496	REAR MOUNT FOR "R" MODELS, 41 AND 47 Series
16	2	1-46238	BRACKET, LIGHT RE-MOUNTING
17	6	3-10127	1/4 x 3/4" SELF TAPPING SCREW
18	1	1-46491	REAR SEAL PANEL FOR "I" MODELS, 28 AND 36 Series
19	1	3-18110	BUBBLE RUBBER, CLIP-ON 180 DEG X 59.00" LONG
20	1	3-18805	FOAM SEAL, 1x1-1/8", 54.00" LONG
21	2	3-18110	BUBBLE RUBBER, CLIP-ON 180 DEG X 36.00" LONG
22	1	1-46494	FENDER SEAL PANEL, LH
23	1	1-46495	FENDER SEAL PANEL, RH
24	2	3-14925	1/4 X 5/8" LONG, HEX FLANGE HEAD BOLT
25	2	3-14924	1/4" FLANGE NUT
26	2	3-19351	REAR LIGHT WIRE EXTENSION HARNESS

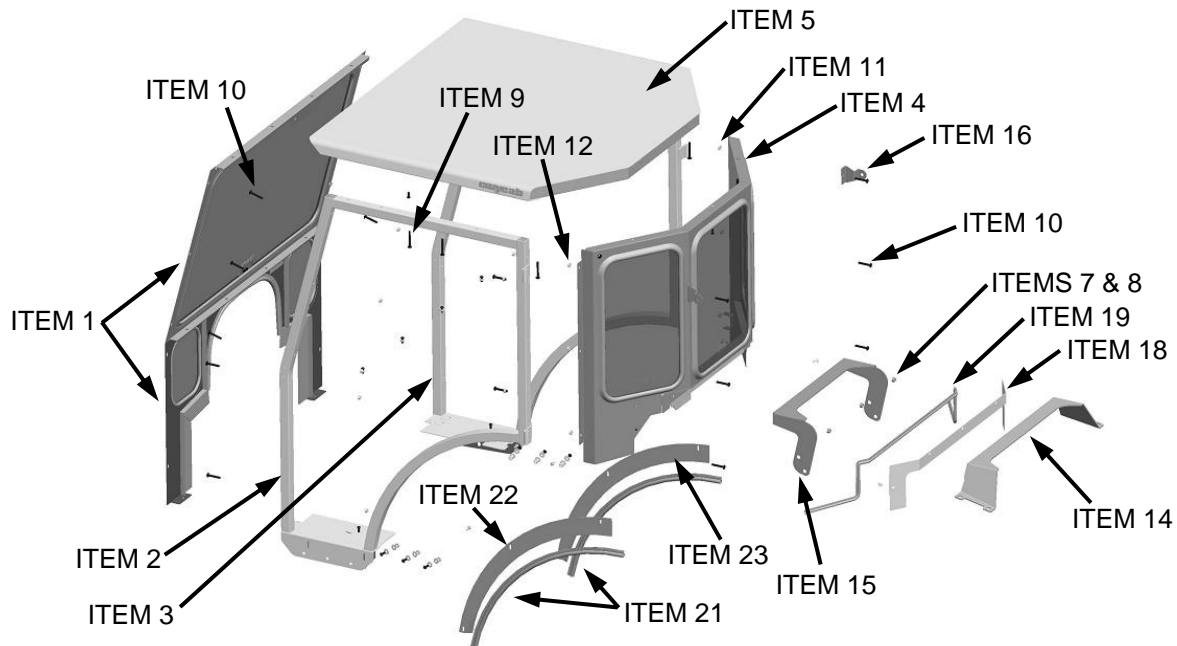

Figure 1
PARTS I.D. AND GENERAL LAYOUT

05-10945_MCCORMICK-LANDINI_CABS.doc
October 12, 2011

CAB FRAME MOUNTING INSTRUCTIONS

Installation tools: Standard and Metric Socket Sets, (2) C-Clamps, torque wrench
Important: Perform all steps correctly and in sequence.

Installation of Cab Frame

1. Park tractor on level surface.
2. Remove rear lights from roll bar.
3. Remove platform steps from each side of tractor.

Installing rear mount and rear window assembly; Complete steps 4-7 for 41 and 47 model series (Skip steps 4 through 7 for 28 and 36 model series);

4. Loosen middle ROPS connection bolts and insert "R" style rear mount bracket, as shown in Figure 2.
5. Re-install ROPS connection bolts and **torque to manufacturer's specifications**, as shown in Figure 2.

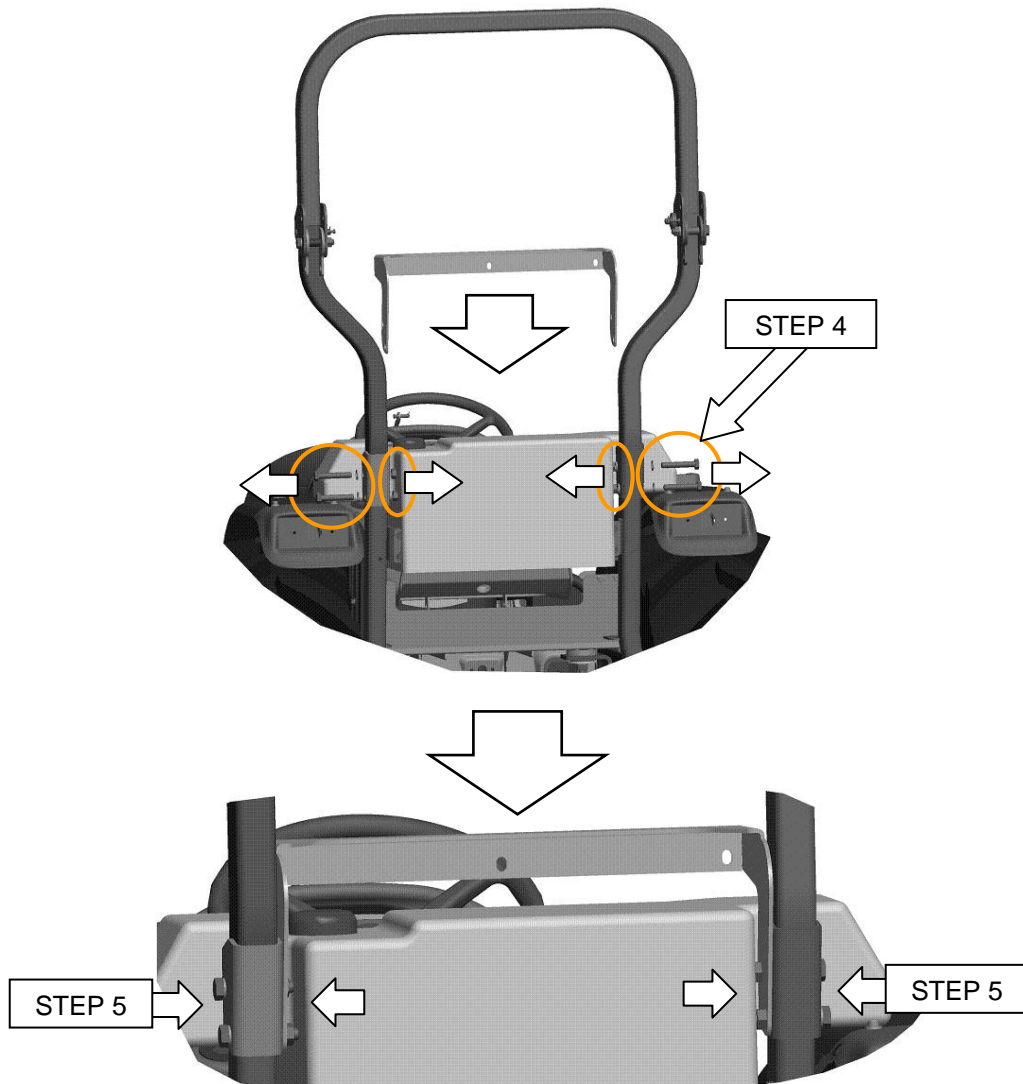

Figure 2
(41 and 47 model series, only)

CAB FRAME MOUNTING INSTRUCTIONS

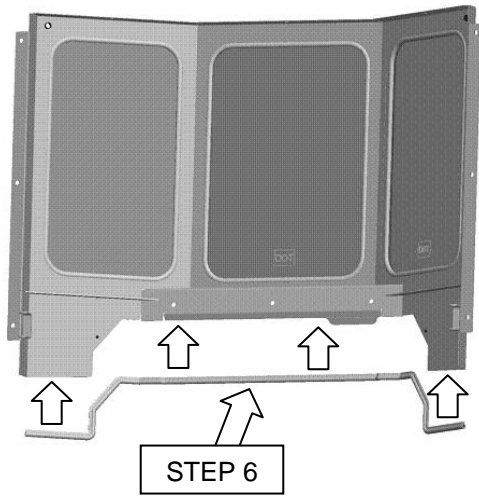

Figure 3
(41 and 47 model series, only)

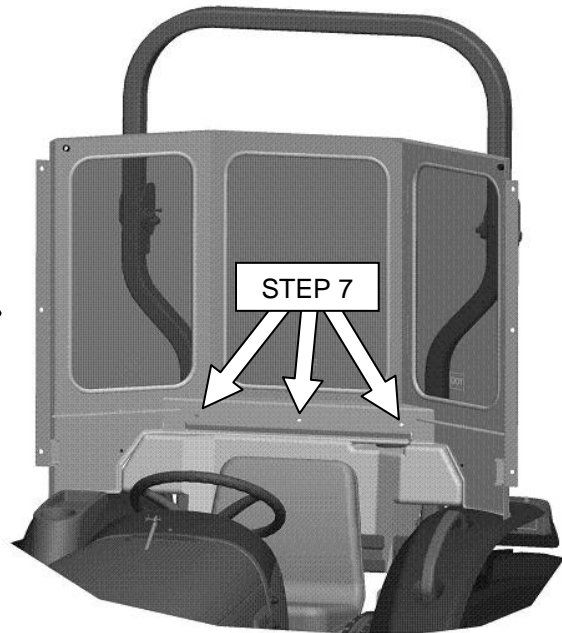

Figure 4
(41 and 47 model series, only)

6. Apply 59" long bubble rubber seal from mount kit to bottom edge of rear panel, as shown in Figure 3.
7. Place rear window panel assembly onto rear mount and secure using (3) 3/8 x 3/4" long head bolts, (3) 5/16" flat washers and (3) 3/8" flange nuts. See Figure 4.

For 28 and 36 models, complete steps 8-13 (For 41 & 47 models, skip steps 8-13);

8. Remove the inner 4 of 8 ROPS bolts that secure the ROPS to mount plates.
9. Place "I" style mount bracket on top of ROPS pads. See Figure 5.
10. Re-install the inner 4 ROPS bolts and **torque to manufacturer's specifications**. See Figure 6.

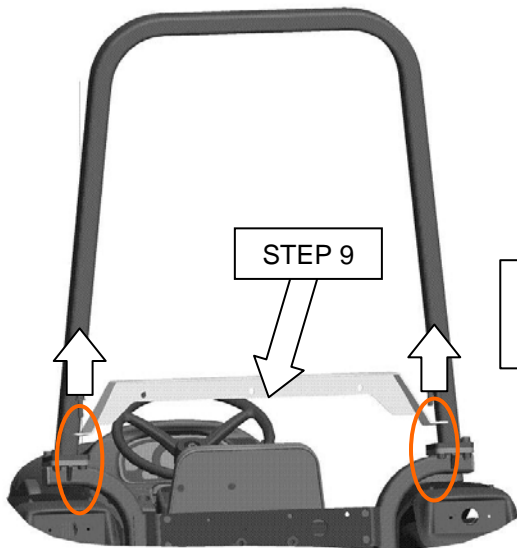

Figure 5
(28 and 36 models, only)

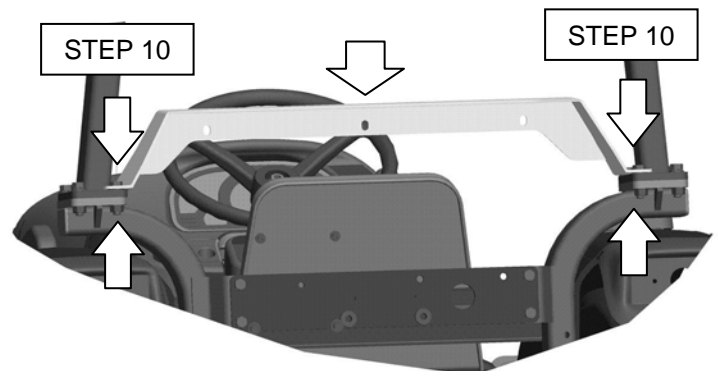

Figure 6
(28 and 36 models, only)

CAB FRAME MOUNTING INSTRUCTIONS

11. Attach "I" type seal panel to bottom of rear window assembly and secure using (2) $\frac{1}{4}$ " x .625" long bolts and (2) $\frac{1}{4}$ " flange nuts, as shown in Figure 7.
12. Attach (1) 59" long bubble rubber seal to bottom of rear seal panel, as shown in Figure 7.
13. Place rear window panel assembly with "I" seal panel and bubble rubber, onto rear mount "I" and secure using (3) $\frac{3}{8}$ x $\frac{3}{4}$ " long head bolts, (3) $\frac{5}{16}$ " flat washers and (3) $\frac{3}{8}$ " flange nuts. See Figure 8.

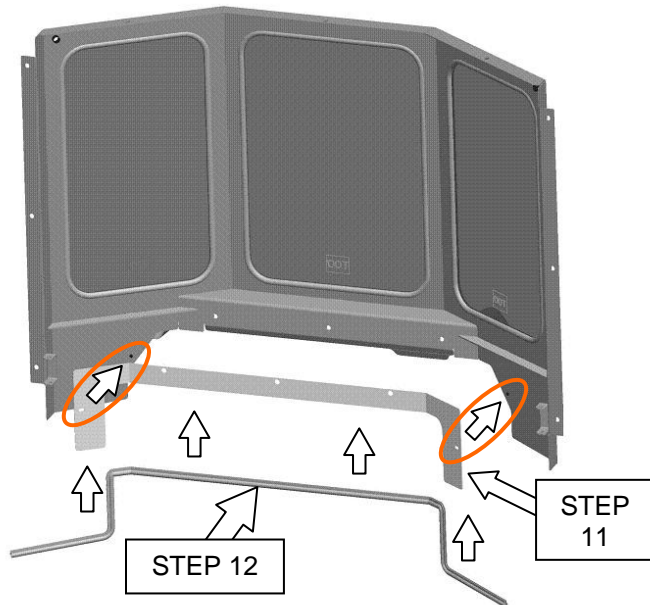

Figure 7
(28 and 36 models, only)



Figure 8
(28 and 36 models, only)

Finishing cab assembly (All models):

14. Position the plate portion of LH side frame onto tractor platform deck. See figure 9.
15. Secure rear of LH side frame and (1) rear light remount bracket to rear panel assembly using (3) $\frac{5}{16}$ " x 2.00" long button head bolts and (3) $\frac{5}{16}$ " flange nuts. Repeat step to mount RH side frame. See figure 10.

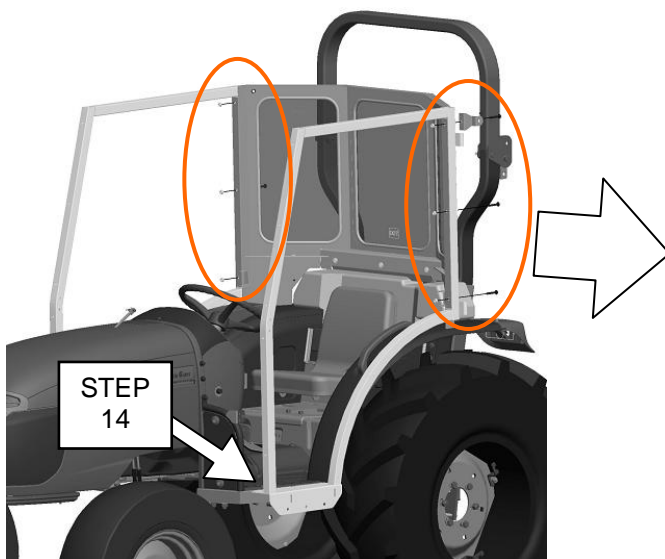

Figure 9

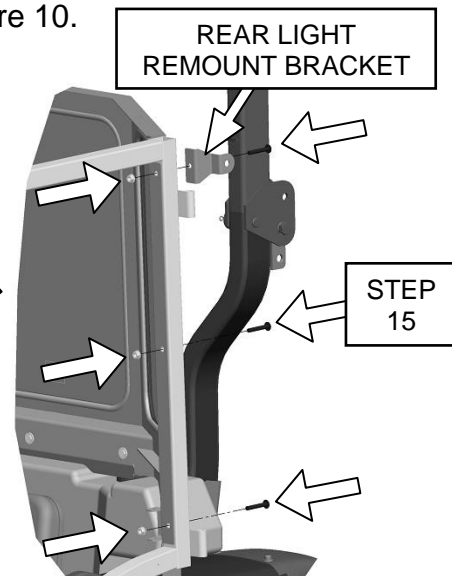

Figure 10

CAB FRAME MOUNTING INSTRUCTIONS

16. Place front lower hood seal assembly onto hood and secure assembly to front of side frame. Secure using (2) 5/16" x 2.00" long button head bolts and (2) 5/16" flange nuts, to each side frame. See figure 11.
17. Secure bottom of front lower hood seal assembly to bottom of each side frame deck plate using (2) 5/16" x 3/4" long button head bolts and (2) 5/16" flange nuts.
18. Secure front upper window assembly to side frames using (3) 5/16" x 2.00" long button head bolts and (3) 5/16" flange nuts on each side. See figure 11.

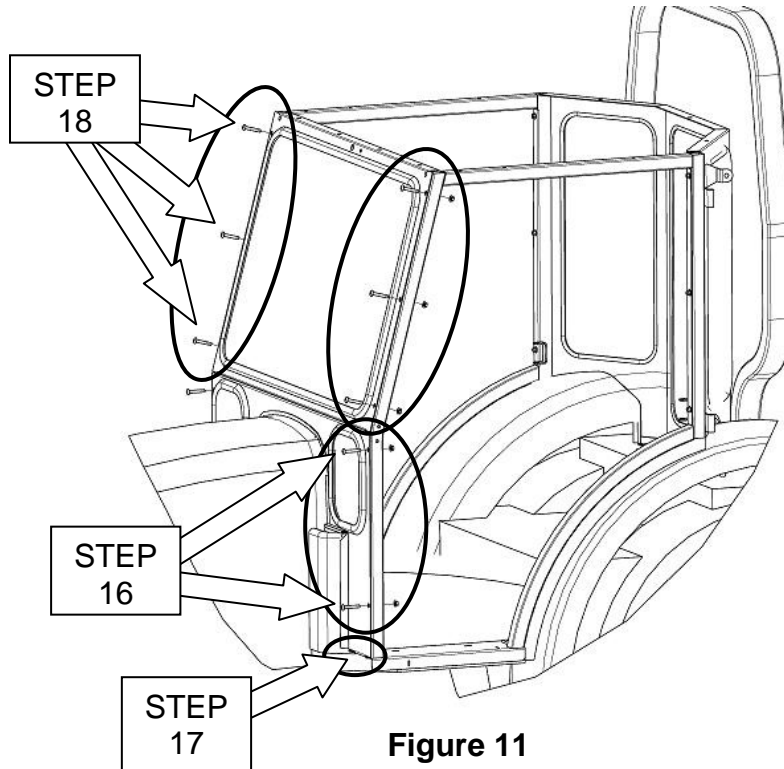

Figure 11

19. Secure front upper and front lower assemblies together using (4) 5/16" x 3/4" long button head bolts and (4) 5/16" flange nuts. See figure 12.
20. To get a proper seal around hood to front panel, apply pressure using C-clamps to secure side frame deck plates downward and inward onto operator's platform. Secure each side frame to tractor floor deck, align holes and secure using (3) 5/16" x 3/4" button head bolts and (3) 5/16" flange nuts. See figures 12 & 14.

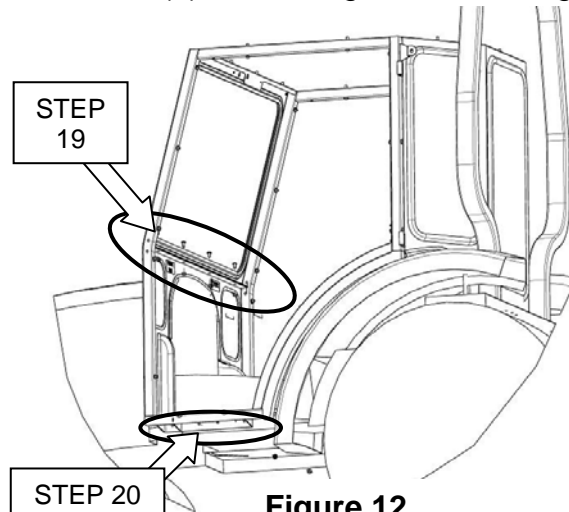

Figure 12

CAB FRAME MOUNTING INSTRUCTIONS

21. Place roof assembly onto cab frame and align with front and rear panels. Secure hardware from bottom upward as noted below;
Front using (4) 5/16" x 3/4" button head bolts
Rear using (3) 5/16" x 3/4" button head bolts
Each side frame using (3) 5/16" x 2.50" long button head bolts on each side. See Figure 13.

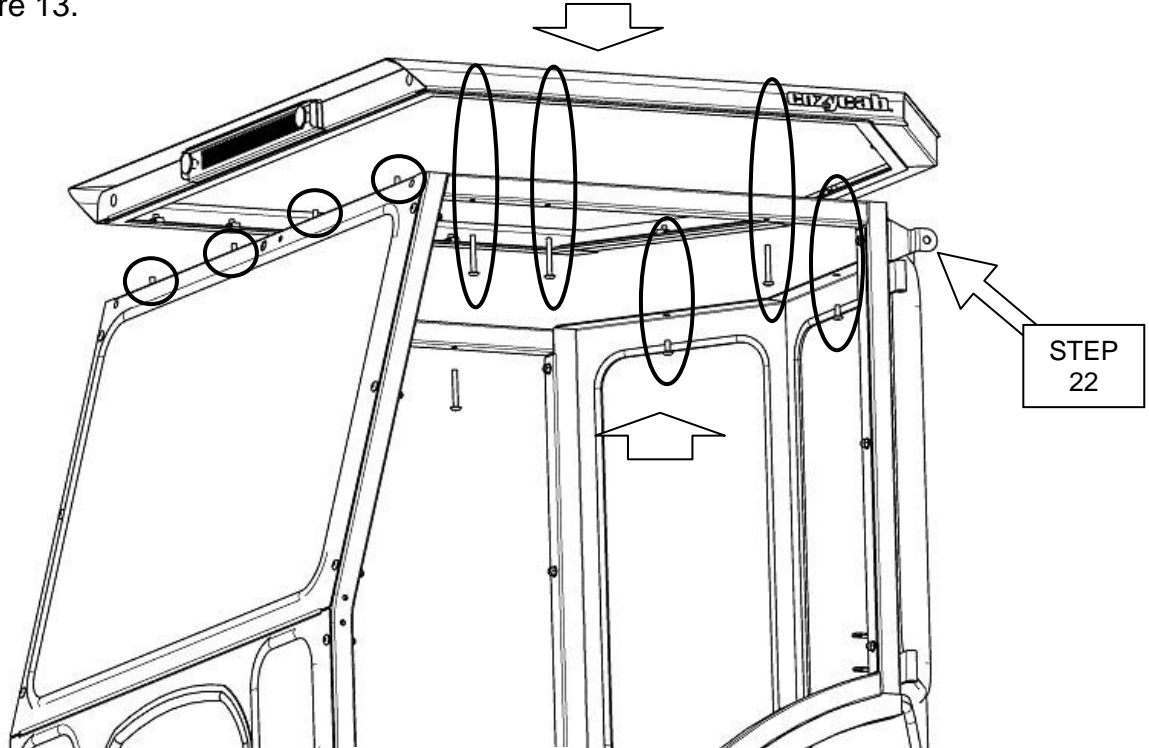

Figure 13

22. Re-attach rear flasher lights to remount brackets reusing same hardware. See figure 13. Using wire extension harness, reconnect rear flasher lights.
23. Remount platform steps to each side of cab reusing the same hardware from step 3. See figure 14.

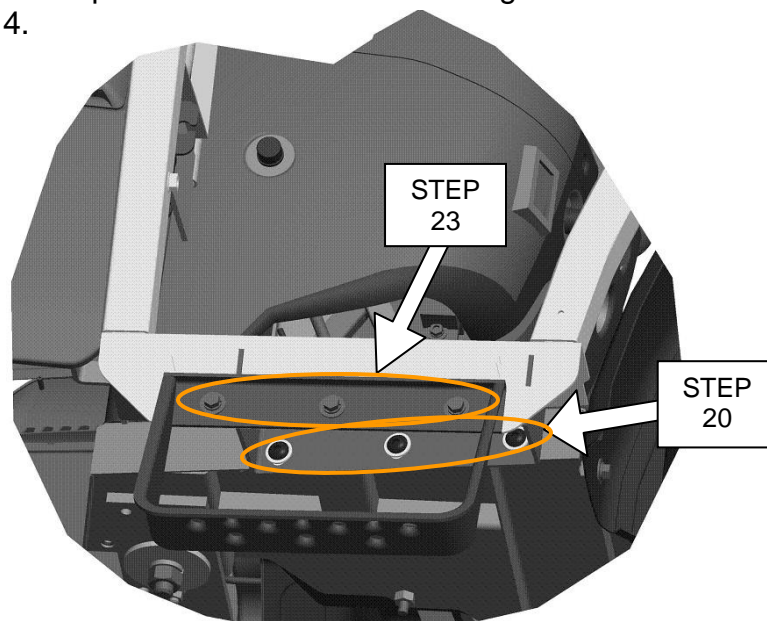

Figure 14

CAB FRAME MOUNTING INSTRUCTIONS

24. Attach 36.00" long bubble rubber to the bottom (inside) radius of each LH and RH fender seal strip. See Figures 15 and 16.
25. Secure fender seal strips with bubble rubber to side frame fender tubes using (3) ¼" self-tapping screws, on each side.

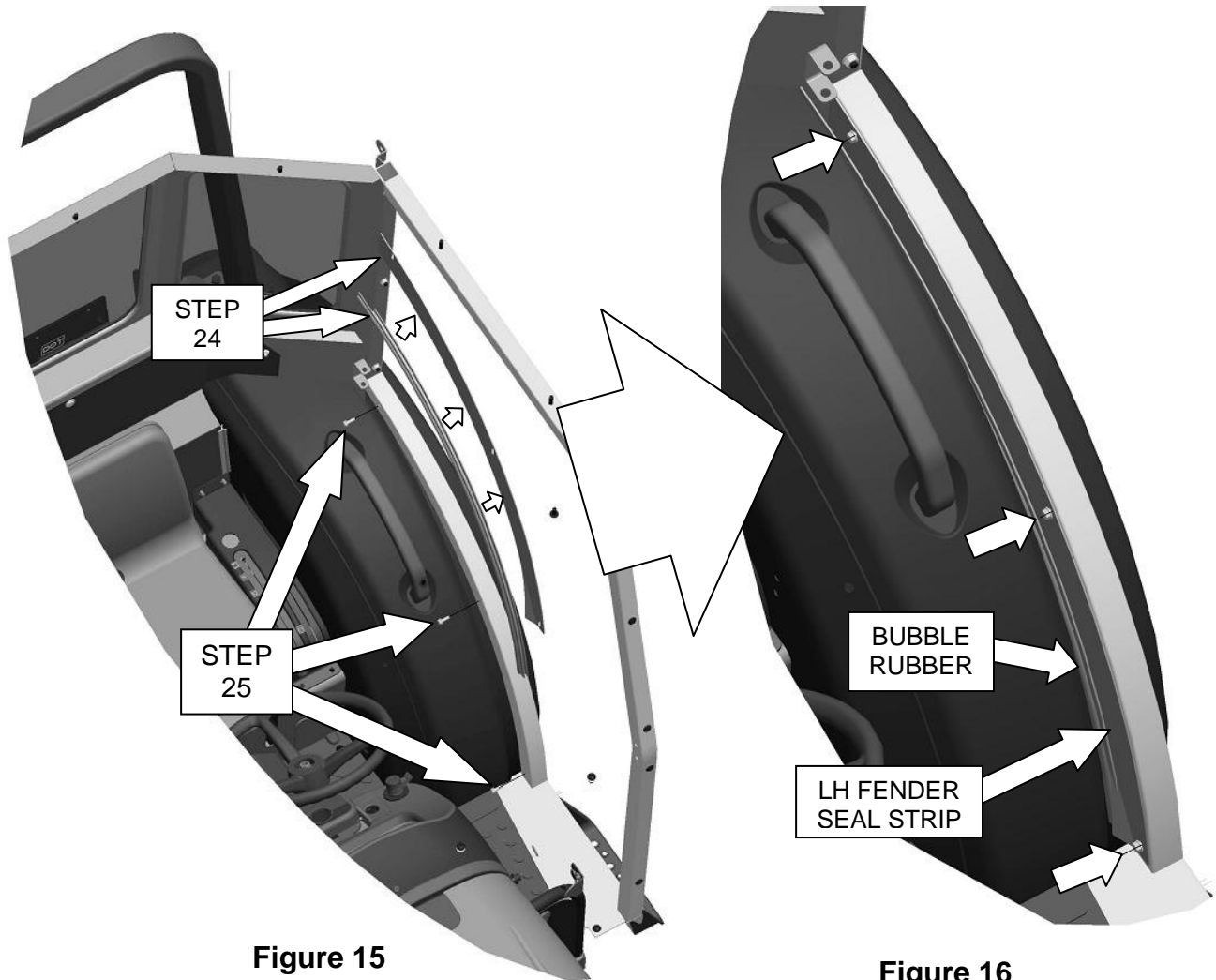

Figure 15

Figure 16

26. One piece of foam seal 1 x 1.125" x 54" is supplied with mount kit for additional sealing of cab, if desired. This can be used to seal small holes and gaps. Cut to fit.
27. Installation is now complete.

Manufactured by:

S CUSTOM PRODUCTS
OF LITCHFIELD, INC.

BOX 70 • LITCHFIELD, MINNESOTA 55355-0070

(320) 693-3221 Fax: (320) 693-7252

www.800cabline.com

05-10945_MCCORMICK-LANDINI_CABS.doc
October 12, 2011