

COZY CABS

TORO CAB

A-11057



MOUNTING INSTRUCTIONS

With Parts Listings to fit
GROUNDMASTER 3000



Manufactured by:

CUSTOM PRODUCTS
OF LITCHFIELD, INC.

BOX 718 • LITCHFIELD, MINNESOTA 55355-0718
(320) 693-3221 Fax: (320) 693-7252
1-800-222-5463



SAFETY INSTRUCTIONS

DANGER: THIS CAB IS NOT A ROPS STRUCTURE AND MUST BE INSTALLED WITH A 2 PART ROPS TO MEET THE ROPS CERTIFICATION.

Read operator's manual. Be thoroughly familiar with the controls, capabilities, and proper use of the equipment.

NEVER ALLOW ANY RIDERS.

Thoroughly inspect Cab and ROPS Cab Mounting periodically.

Stay alert for hidden hazards and traffic.

Avoid sudden starts, excessive speeds, and sudden stops when operating on hillside, rough ground and most off-the-road operations.

Use extreme care when working close to fences, ditches, or on hillsides.

Wait for tractor to STOP before dismounting.

Check clearance carefully before driving under any objects.

Avoid operating sideways on a steep slope whenever possible.

Never exceed factory recommended specifications.

Do not weld, cut, drill or modify ROPS in any manner unless instructed by manufacturer.

MOUNTING INSTRUCTIONS

(TORO GROUNDSMASTER 3000)

1. PREPARATION OF MACHINE.

- Disconnect the battery to avoid damage to the electrical system during the wiring hook up of the cab.
- Raise the seat.
- Drill two 1 1/8" holes to rout the heater hoses (see fig. #1), and a 1/2" hole to route the power wire. (see fig. #1)
- Remove the instrument panel cover.

2. INSTALLATION OF CAB

- Lower cab onto machine frame.
- Fasten the cab to the machine frame using (6) 3/8" x 1.0" bolts, (12) 3/8" flat washers, and (6) 3/8" Nylock hex nuts supplied in the mounting kit.

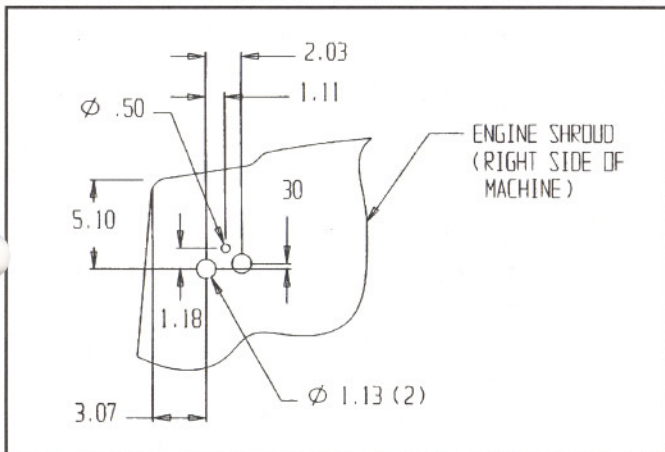

FIGURE 1

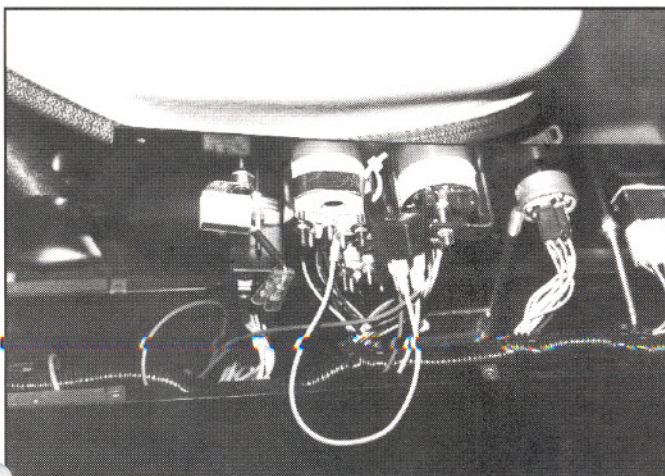

FIGURE 2

3. ELECTRICAL HOOK UP

- Tie the relay switch to the temperature gauge mounting bracket using the cable tie supplied in the mounting kit. (see fig. #2)
- Fasten the circuit breaker to the bracket located on the inside of the engine shroud using a #10 x 1.0" bolt, flat washers (2) and Nylock nut supplied in the mounting kit. (see fig. #3).
- Snap in the 1/2" grommet supplied in the mounting kit into the hole drilled into the engine shroud in step 1-C.

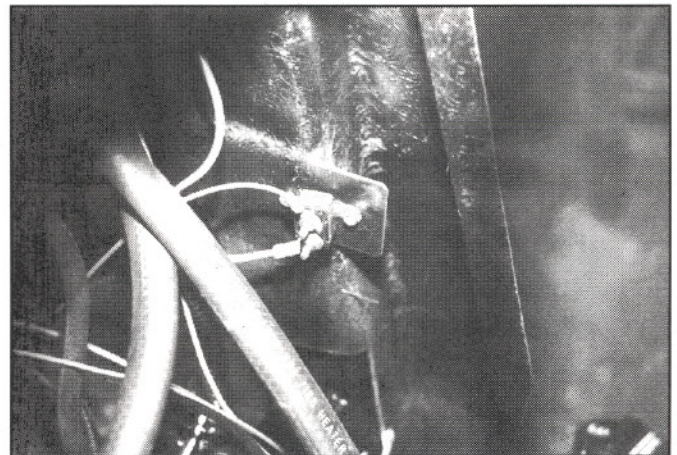

FIGURE 3

- Route the fuse block power wire, cab ground wire and road light tie-in wire through the grommet and connect the power wire to the silver post on the circuit breaker, and the ground wire to the ground cable located under the starter motor. (See fig. #4.) Tie up the road light wire for future use.
- Refer to the wiring diagram to make the remaining wire connections to the relay.
- Check the power inside the cab to be sure all the wire connections were made correctly. (Power should work with the key in the "ON" position only.)
- Reinstall the instrument panel cover.
- Reconnect the battery.

4. HEATER HOOK UP (GAS)

- Cut the heater hoses inside the cab at the height of the holes drilled in the engine shroud in step 1-C.
- Snap the 1 1/8" grommets into the holes drilled into the engine shroud.
- Connect the 90 deg. elbows to the hoses using a #10 hose clamp. (See fig. #5.)

- D. Connect the pieces of hose cut off in step 4-A to the elbows using the #10 hose clamps and route the hoses through the grommets snapped into the engine shroud. (See fig. #5.)
- E. Locate the bypass hose on the left side of the engine and place two clamps on the hose approximately 6" apart from each other to prevent leakage of the coolant when the hose is cut to attach the heater hose.
- F. Cut the bypass hose between the two clamps and install the hose splices provided in the mounting kit with a #10 hose clamp also supplied in the mounting kit.

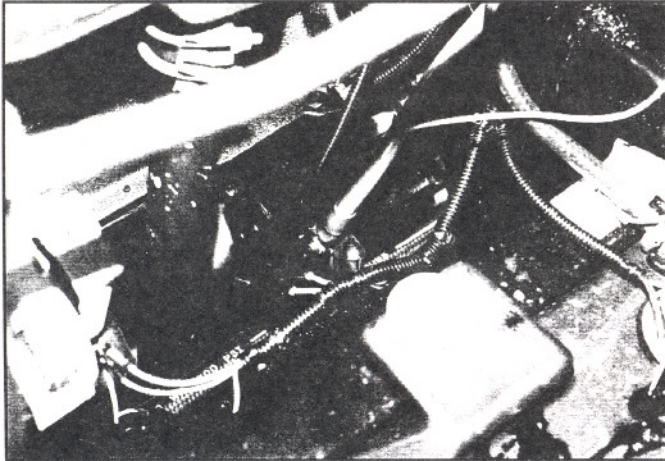

FIGURE 4

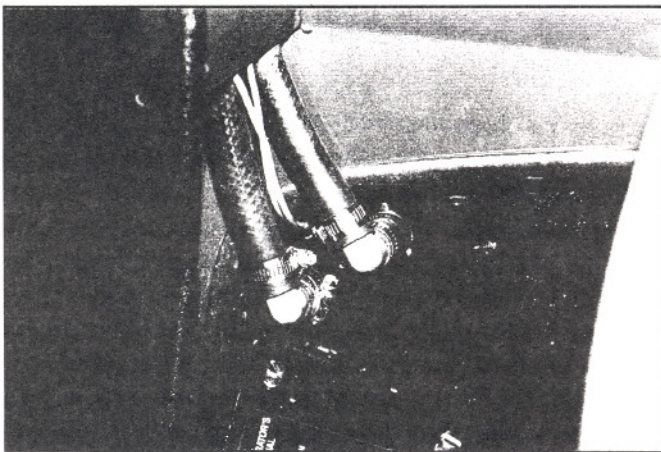

FIGURE 5

- G. Connect the hose marked inlet to the bypass hose that is routed to the rear of the engine (front of machine) using a #10 hose clamp. (Hoses must be connected correctly for the heater control valve to work properly.)
- H. Connect the other heater hose to the bypass hose routed to the front side of the engine, using a #10 hose clamp.
- I. Start the engine and run at a high idle with the push/pull cable pulled out until circulation is complete.

- J. Coolant will need to be added to the system to allow for the coolant needed to fill the heater core.

5. HEATER HOOK UP (DIESEL)

- A. Remove the 8mm restrictor from the bypass hose on the right side of the engine. (Left side of machine) The restrictor is located in the "T" near the front of the engine. (Rear of machine)
- B. Cut the heater hoses inside the cab at the height of the holes drilled in the engine shroud in step 1-C.
- C. Snap the 1 1/8" grommets into the holes drilled into the engine shroud.
- D. Connect the 90 deg. elbows to the hoses using a #10 hose clamp. (See fig. #5.)
- E. Connect the pieces of hose cut off in step 5-A to the elbows using the #10 hose clamps and route the hoses through the grommets snapped into the engine shroud (See fig. #5.)
- F. Locate the bypass hose on the left side of the engine and place two clamps on the hose approximately 6" apart from each other to prevent leakage of the coolant when the hose is cut to attach the heater hose.
- G. Cut the bypass hose between the two clamps and install the hose adapters provided in the mounting kit with a #10 hose clamp also supplied in the mounting kit. (See fig. #6.)
- H. Connect the hose marked inlet to the bypass hose that is routed to the rear of the engine (front of machine) using a #10 hose clamp. (Hoses must be connected correctly for the heater control valve to work properly.)
- I. Connect the other heater hose to the bypass hose routed to the front side of the engine, using a #10 hose clamp.
- J. Start the engine and run at a high idle with the push/pull cable pulled out until circulation is complete.
- K. Coolant will need to be added to the system to allow for the coolant needed to fill the heater core. (A Toro approved coolant must be used in the diesel engine.)

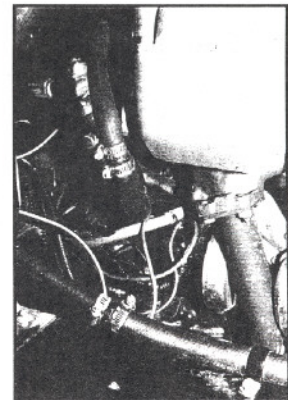
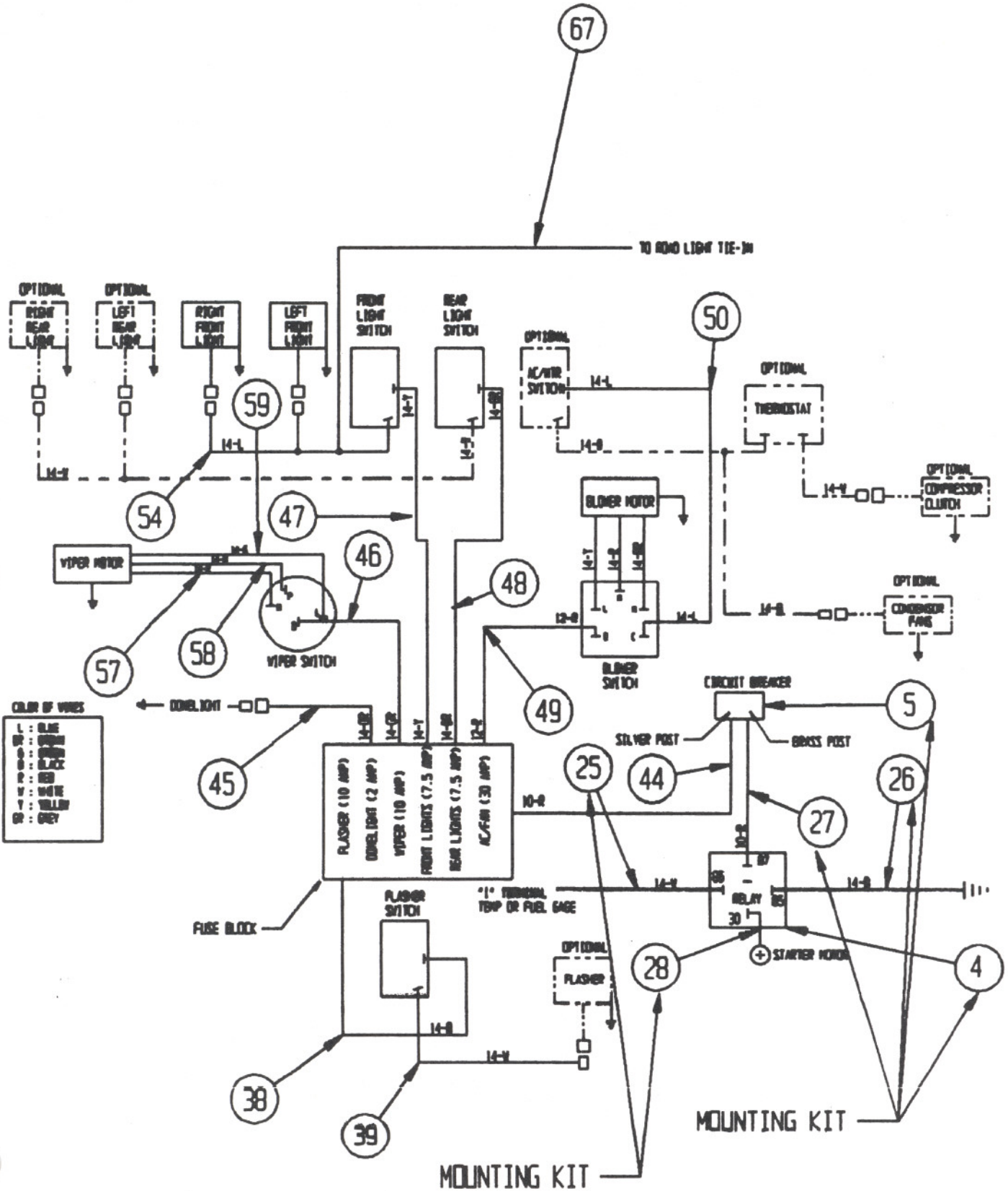
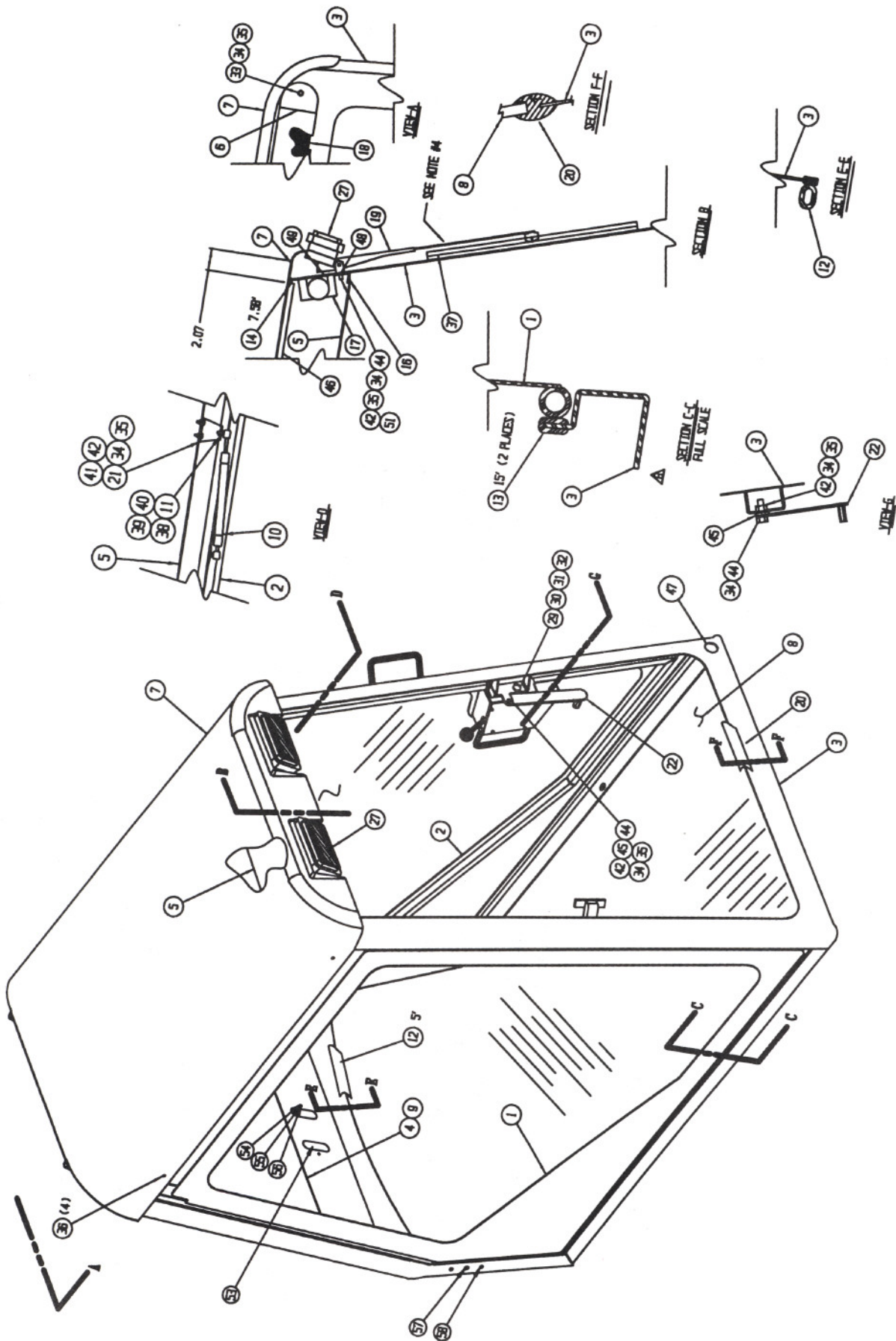

FIGURE 6

WIRING DIAGRAM





REPLACEMENT PARTS TORO 3000 CAB ASSEMBLY

PART NO.	QTY.	DESCRIPTION	ITEM NUMBER
8-13326	1	Door Assembly, Right	1
8-13267	1	Door Assembly, Left	2
3-16523	1	Window Assy, Swingout, Rear	4
8-13277	1	Assembly, Headliner	5
6-34232	1	Cover, Air Filter	6
3-16663	1	Roof, Fiberglass	7
3-16578	1	Glass, Windshield	8
3-10649	7.5'	Rubber, Offset, Window	9
3-11929	1	Gas Spring, 6" Stroke	10
3-11821	1	Ball Stud, Gas Spring	11
3-10609	5'	Rubber, Clip-On, Small	12
3-15952	30'	Trim Seal, 3/4" Bubble	13
3-15068	7.5'	Trim Seal, 3/8" Bubble	14
3-11265	11'	1/4" x 1" PSA Polyfoam	15
6-37473	1	Front Panel Stiffener	16
3-12497	1	Wiper Motor	17
3-15944	1	Air Filter	18
3-15776	1	Wiper Arm	19
3-10648	12.5'	Window Rubber, Inline	20
6-37509	1	Ball Stud Mount	21
7-14795	1	Weldment, Door Prop	22
3-16658	2	Work Light	27
3-15407	1	Striker Stud	29
3-10066	1	7/16" Hex Nut	30
3-10152	1	7/16" Lock Washer	31
3-10166	1	7/16" Flat Washer	32
3-14921	2	1/4" Acorn Nut	33
3-10084	7	1/4" Flat Washer	34
3-10076	7	1/4" Lock Washer	35
3-13621	4	#14 Selftapping Screw	36
3-15763	1	Wiper Blade	37
3-10064	1	5/16" Hex Nut	38
3-10085	1	5/16" Flat Washer	39
3-10077	1	5/16" Lock Washer	40
3-10219	2	1/4" x 3/4" Bolt	41
3-10063	5	1/4" Hex Nut	42
3-10220	3	1/4" x 1" Bolt	44
3-10112	1	5/16" Fiber Washer	45
6-37679	1	Polyfoam, Roof	46
3-10724	1	1 1/4" Hole Plug	47
3-10727	2	1/4" Grommet	48
3-16305	1	Gasket, Wiper	49
3-16678	1	Decal, Caution	50
6-41642	1	Cover Plate	53
3-10105	4	MSCR, #10-24 NC x 3/4"	54
3-10308	4	#10 Hex Nut	55
3-10083	4	Washer, 3/16"	56
3-10722	2	7/16" Plug	57
3-15014	4	5/16" Plug	58

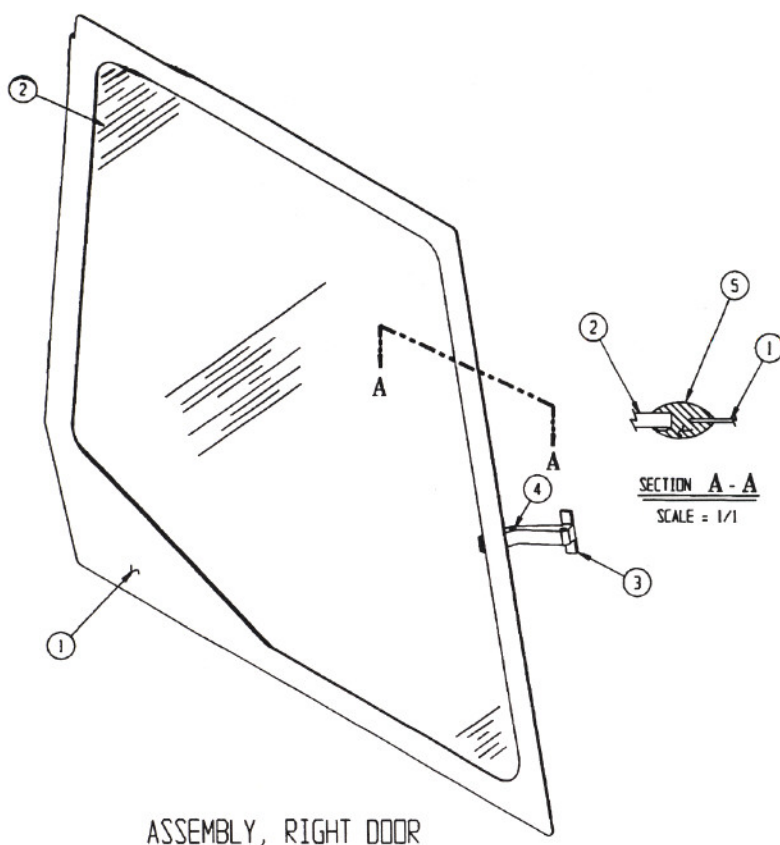

REPLACEMENT PARTS TORO 3000 RIGHT DOOR ASSEMBLY

PART NO.	QTY.	DESCRIPTION	ITEM NUMBER
7-14710	1	Weldment, Right Door	1
3-16576	1	Glass Right Side Door	2
3-15572	1	Handle, Plastic	3
3-15576	1	Roll Pin	4
3-10648	12'	Window Rubber, Inline	5

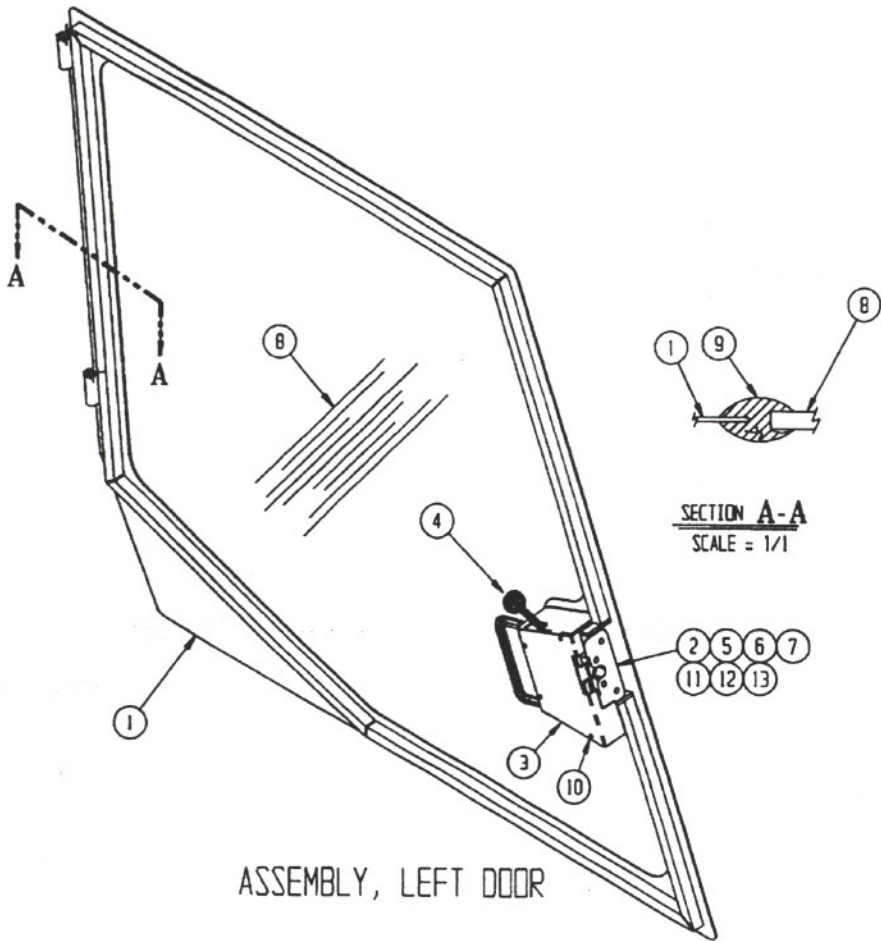

REPLACEMENT PARTS TORO 3000 LEFT DOOR ASSEMBLY

PART NO.	QTY.	DESCRIPTION	ITEM NUMBER
7-14711	1	Weldment, Left Door	1
6-37365	1	Linkage, Latch	2
6-37364	1	Latch Cover	3
7-14774	1	Weldment, Paddle Handle	4
3-14231	1	Knob, Round	4A
3-14349	1	Latch, Rotary	5
3-15794	1	Rod Clip, Right Hand	6
3-15795	1	Rod Clip, Left Hand	7
3-16577	1	Glass, Left Door	8
3-10648	13'	Window Rubber, Inline	9
3-10295	4	#10 Self tapping Screw x 5/8"	10
3-10204	4	1/4" x 1 1/2" Bolt	11
3-10076	4	1/4" Lock Washer	12
3-10063	4	1/4" Hex Nut	13

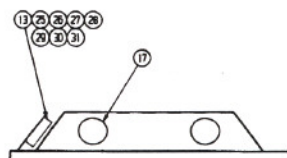
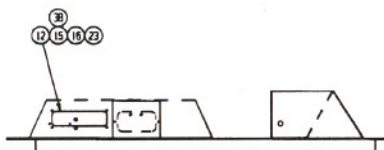
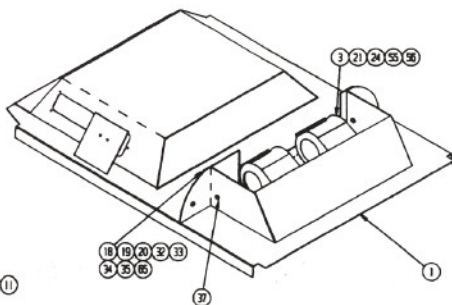
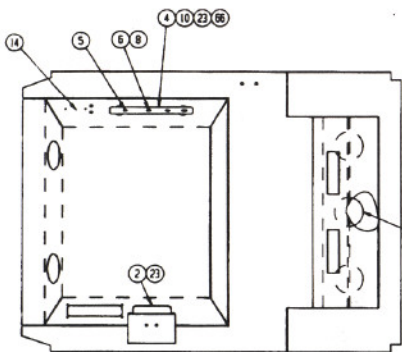

REPLACEMENT PARTS TORO 3000 HEADLINER ASSEMBLY

PART NO.	QTY.	DESCRIPTION	ITEM NUMBER
7-14742	1	Weldment, Headliner	1
6-36057	1	Cover, Fuse	2
3-15935	1	Blower, 235 CFM	3
6-37482	1	Switch Mounting Plate	4
3-11149	1	Push Pull Cable	5
3-11173	1	Knob, Switch, Plastic	6
3-15432	1	Switch, 3 Speed	8
3-15594	3	Louver, Black	11
3-16274	1	Switch, Rocker	12
3-16033	1	Fuse Block	13
3-16232	1	Dome Light	14
3-11111	1	Switch, Wiper	15
6-37263	1	Switch Plate	16
3-15928	2	Louver, Black	17
3-16572	1	Heater Core	19
3-11202	2	Gasket, Blower	21
3-11812	10	#10 x 5/8" Selftapping Screw	23
3-10135	4	#10 x 1" Mach. Screw	24
3-10101	2	1/4" x 1 1/2" Mach. Screw	25
3-16580	1	Fuse, Blade Type, 30 Amp	26
3-16057	1	Fuse, Blade Type, 10 Amp	27
3-16581	1	Fuse, Blade Type, 7.5 Amp	28
3-16582	1	Fuse, Blade Type, 2 Amp	29
3-10063	2	1/4" Hex Nut	30
3-10076	2	1/4" Lock Washer	31
3-11172	16'	Heater Hose	32
3-10858	11	#10 Hose Clamp	33
3-16692	1	Valve, Heater Temp Control	34
3-16677	2	Plug, Rocker Switch Hole	36
3-10729	4	1/2" Grommet	37
6-37655	2	Polyfoam, Sides	60
6-37656	1	Polyfoam, Back	61
6-37657	1	Polyfoam, Top	62
6-37658	1	Polyfoam, Top, Upper	63
6-37659	2	Polyfoam, Lower Sides	64
3-16672	2	Frame Clips	65
3-16675	1	Decal, Push/Pull, Blower	66
3-10282	2	Elbow, 90 Deg.	67

PARTS LIST TORO 3000 MOUNTING KIT

PART NO.	QTY.	DESCRIPTION
3-10086	12	3/8" Flat Washer
3-10147	6	3/8" x 1" Bolt
3-10073	6	3/8" Nylock Nut
3-12955	1	Relay, 30 Amp
3-11317	1	Circuit Breaker, 40 Amp
3-11738	2	1 1/8" Grommet
3-10858	8	#10 Hose Clamp
3-10282	2	90 Deg. Plastic Elbow
3-10728	1	1/2" Grommet
3-16032	1	#10 x 1" Bolt
3-10083	2	3/16" Flat Washer
3-10308	1	#10 Nylock Nut
8-13395	1	Wire Assy, Relay To "I" Term.
8-13396	1	Wire Assy, Relay To Ground
8-13397	1	Wire Assy, Relay To Circuit Breaker
8-13394	1	Wire Assy, Relay To Starter Motor
3-10726	1	Wire Tie Nylon, 3 3/4" Long
3-16055	2	Adapter, .75 to .625 Hose
3-16693	2	Fitting, Heater Hose
6-10694	2	Hose Splice