



A-12099

TEMPERED GLASS HARD DOORS KIT

FOR JDX MY14 COZY CABS A-12098

Before you begin, read these instructions and identify all components. Please retain these instructions for future reference and parts ordering information.

Note: Cab should be installed prior to installing doors kit. Refer to kit components and Figure 1 for general layout.

Kit Components:

| ITEM | QTY | PART No. | DESCRIPTION |
|------|-----|----------|-------------------------------------|
| 1 | 1 | 4-16059 | DOOR ASSEMBLY, LH |
| 2 | 1 | 4-16060 | DOOR ASSEMBLY, RH |
| 3 | 1 | 4-16070 | HARDWARE KIT, CONSISTS OF ITEMS A-E |
| A | 2 | 3-11821 | BALL STUD |
| B | 4 | 3-15971 | BRASS WASHER FOR HINGE |
| C | 2 | 3-18070 | JAM NUT, M10 |
| D | 2 | 3-19563 | STRIKER STUD, M10 X 13MM LG |
| E | 1 | 05-11533 | MOUNTING INSTRUCTIONS |

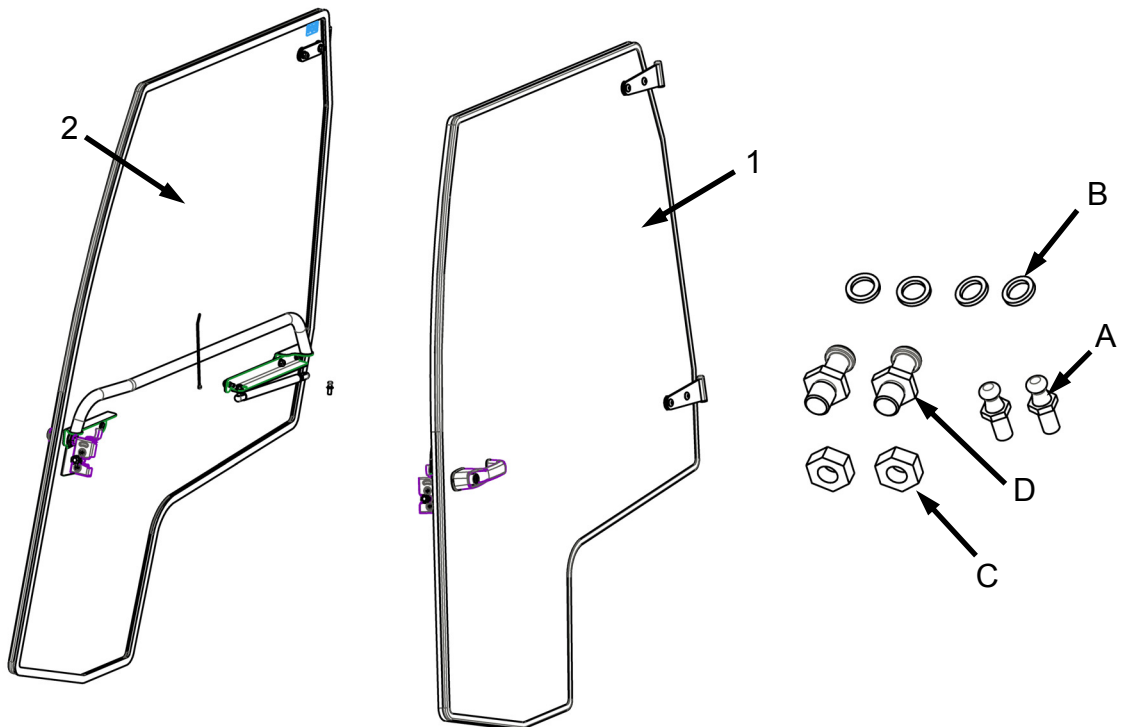
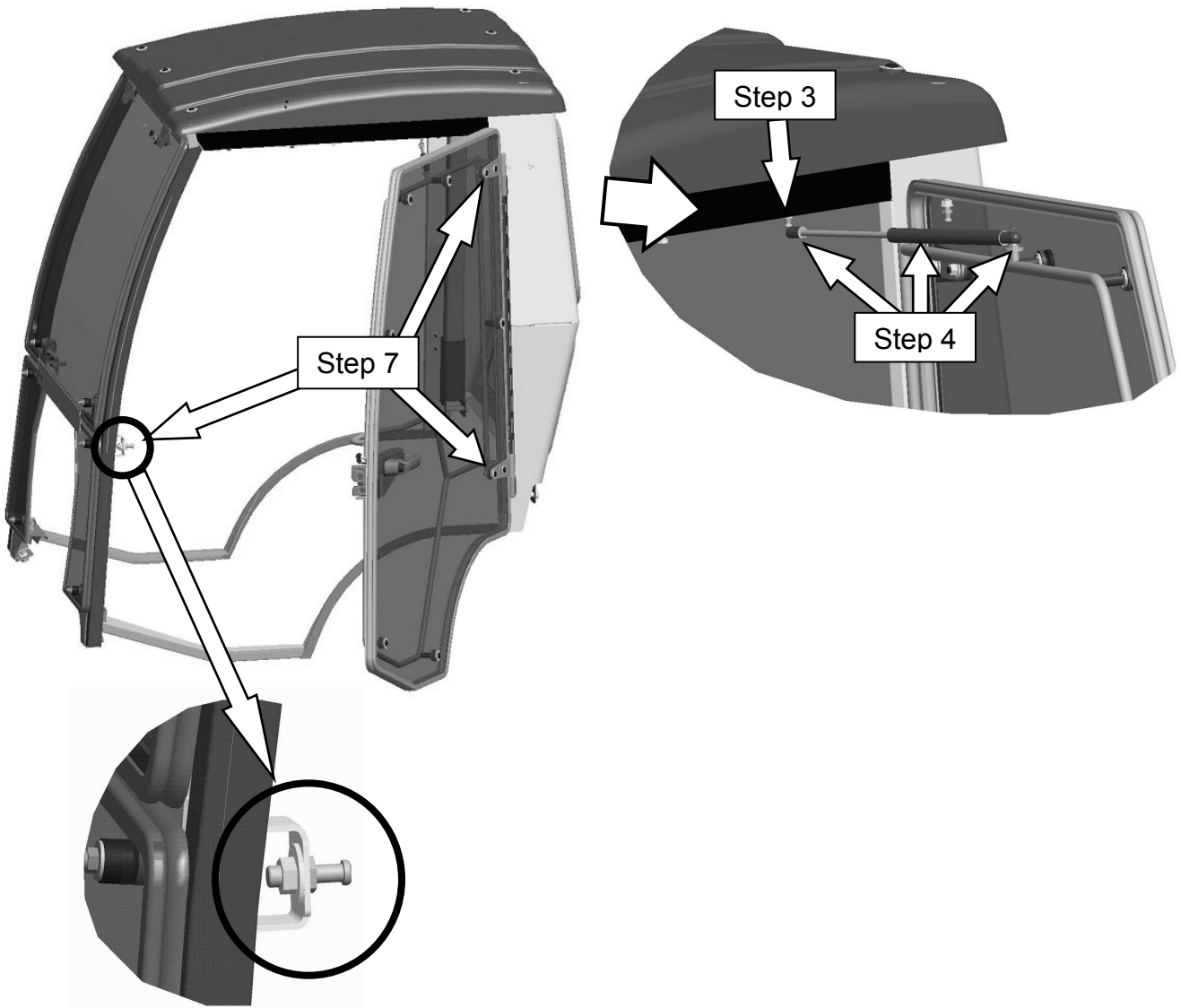

Figure 1
(General Layout)

MOUNTING INSTRUCTIONS

Mounting the doors (If not already installed from factory);

1. Place brass washer (B) onto each door mount hinge pin.
2. Place LH door assembly (1) onto LH door mount pins.
3. Install ball stud (A) onto each side of cab header.
4. Connect gas spring to cab header panel ball stud (A) using gas spring already installed on door.
5. Install 10mm striker stud (D) onto front LH cab frame striker mount location. Secure stud using a 10mm jam nut (C).
6. Locate door handle keys (Supplied tied to inside door handle from factory) and set aside.
7. The latch is a 2-position rotary latch. Close and open door. The correct latch position would be the 2nd (Click) inward position, when closed. Adjust striker stud (D) and glass door hinges as needed to get proper alignment.
8. Repeat steps 2 through 7 on RH side of cab using RH components.



CUSTOM PRODUCTS ©2014
OF LITCHFIELD, INC.

PO BOX 70, 1715 S. Sibley Avenue, Litchfield, MN 55355-0070
Ph: (320) 693-3221 Fax: (320) 693-4833
www.800cabline.com

05-11533
December 10, 2013

| REV | DCR # | DESCRIPTION | DATE | CHG BY |
|-----|-------|---------------------------------------|----------|--------|
| A | 12686 | ADDED DOOR LIMITER PICTURE AND NOTE 2 | 12-22-16 | CAD |

| ITEM # | DESCRIPTION | QTY |
|--------|----------------------|-----|
| 1 | 4-16059_DOOR_LH | 1 |
| 2 | 4-16060_DOOR_RH_MIR | 1 |
| 3 | 4-16070_HARDWARE_KIT | 1 |

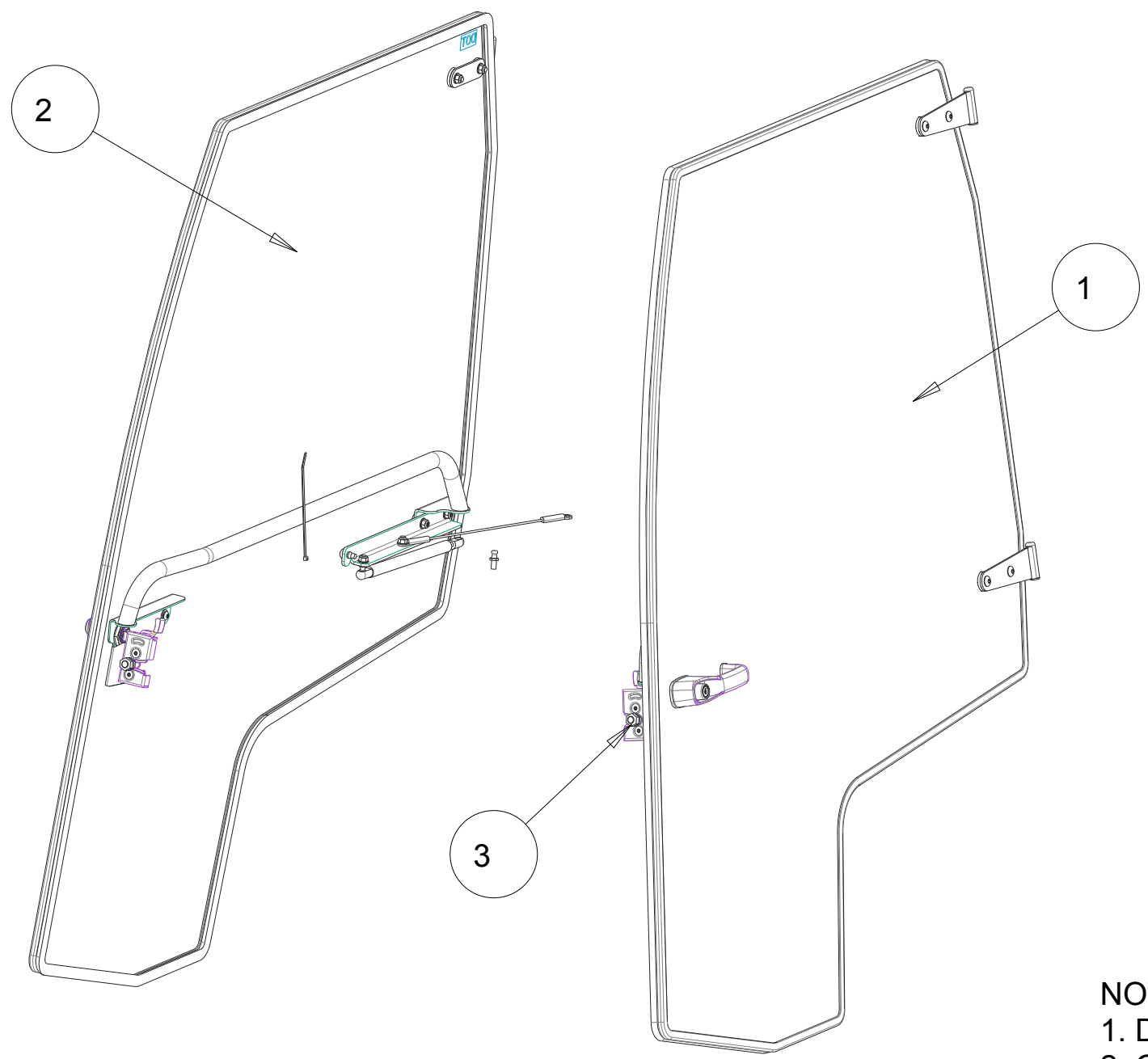

NOTE 2 PICTURE

NOTE;
 1. DOORS ARE NORMALLY HUNG ONTO CAB A-12098 WHEN SHIPPING
 2. CONNECT DOOR LIMITER CABLE TO CAB AS SHOWN IN PICTURE

SCALE 0.100

THIS DOCUMENT CONTAINS CONFIDENTIAL INFORMATION AND IS THE PROPERTY OF CUSTOM PRODUCTS, AND MAY NOT BE COPIED, REPRODUCED OR DISCLOSED IN ANY MANNER WITHOUT EXPRESS WRITTEN CONSENT FROM CUSTOM PRODUCTS

| | | | | |
|--|--|------------------|---|---------------------------|
| INTERPRET PER: ASME Y14.5M-1994 | ENGINEER CAD | DATE 09-30-13 | CUSTOMER JD AFTERMARKET | MODEL NUMBER JDX MY 14 |
| UNITS: INCH | DRAWN CAD | DATE 09-30-13 | TITLE DOORS KIT, GLASS INSTALLED ON CAB | |
| TOLERANCES UNLESS OTHERWISE SPECIFIED | 1715 South Sibley Ave Litchfield, MN 55355-0070 | | DWG. NO A-12099 | REV A |
| 1 PL.± 0.1 3 PL.± 0.001 | | | | |
| 2 PL.± 0.01 HOLES± .015 | | | | |
| ANGULAR TOL.± 0.5° | THIRD ANGLE PROJECTION | | | |

A-12099

NAME:CAD2 OBJECT:4-16059 DATE:25-Feb-14 07:59:16

| REV. | DCR NO. | DESCRIPTION | DRAFTSMAN | DATE |
|------|---------|--------------------------------|-----------|----------|
| A | - | GAS SPRING 3-18584 WAS 3-13024 | CAD | 10-18-13 |
| B | 11185 | ADDED LANYARD, NUT AND BOLT | CAD | 01-21-14 |
| C | 11236 | BOLT 3-19055 WAS 3-18312 | CAD | 02-25-14 |

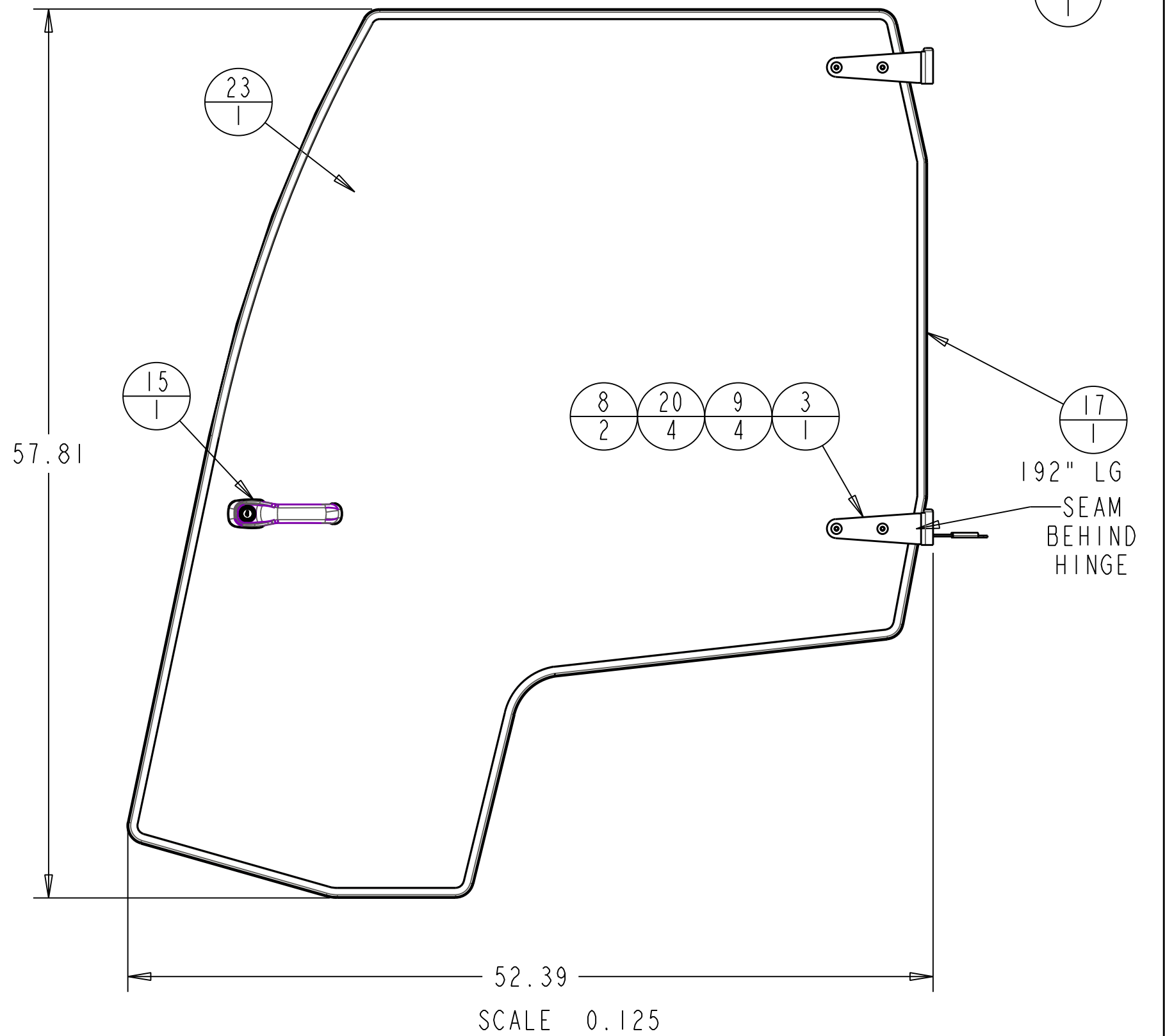
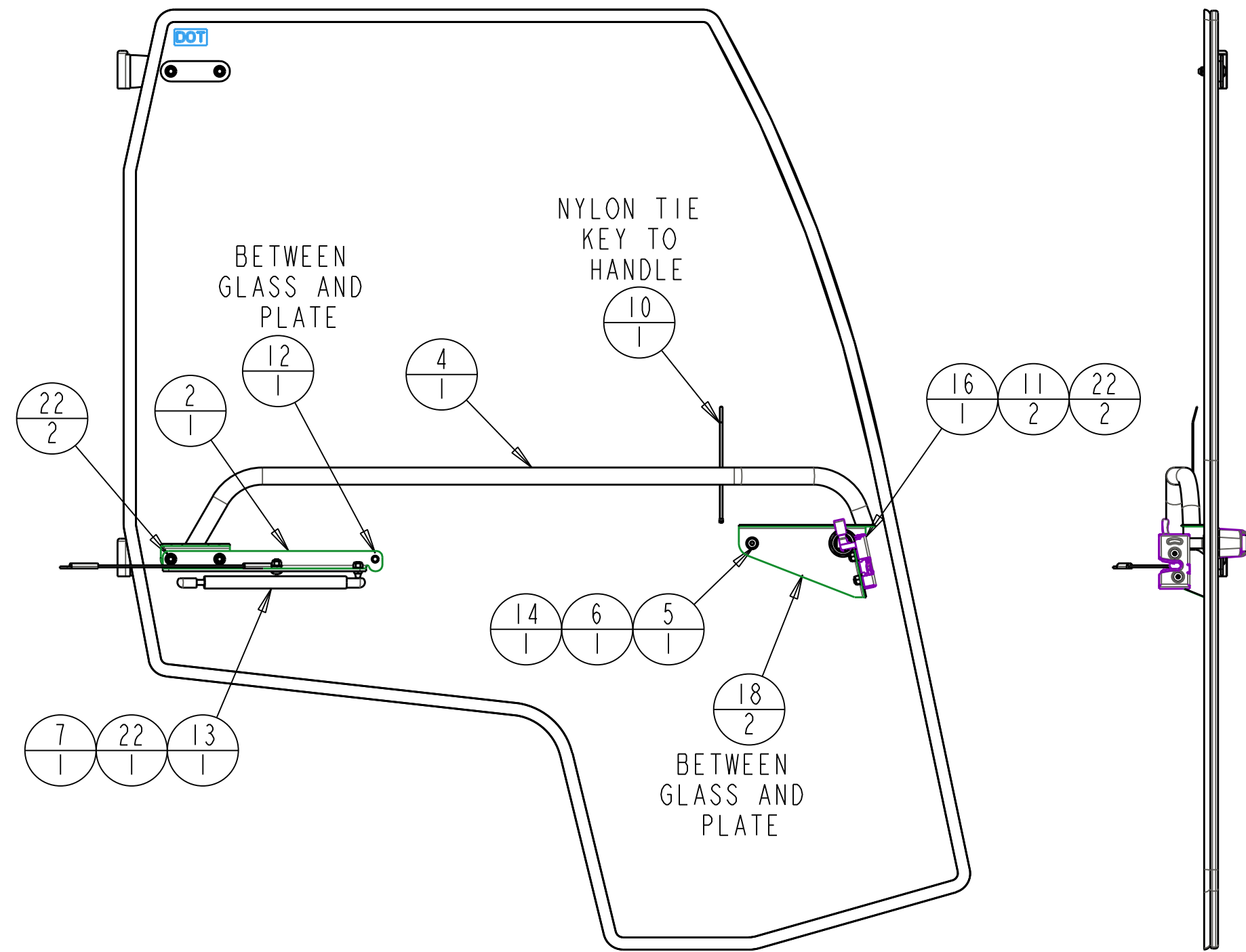
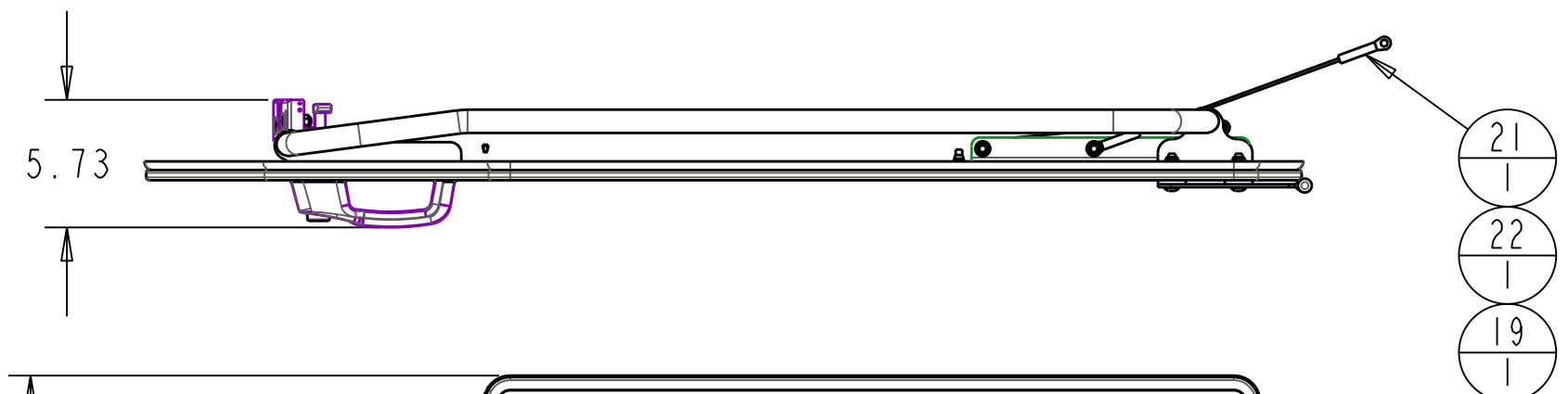
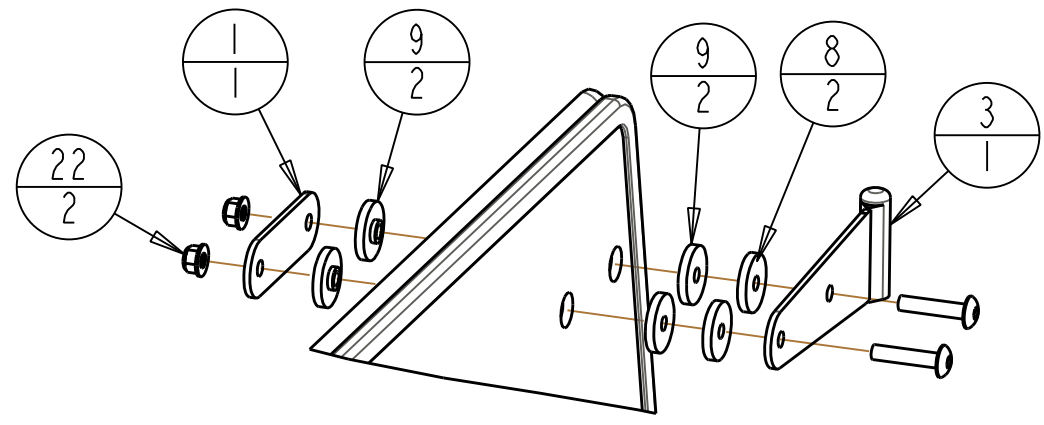

SCALE 0.125

| ITEM # | DESCRIPTION | QTY | ITEM # | DESCRIPTION | QTY |
|--------|---------------------------------|-----|--------|---------------------------------|-----|
| 1 | 1-48564_CAP_PLATE | 1 | 12 | 3-18480_RUB BUMPER_W_FLANGE | 1 |
| 2 | 1-49228_GS_MOUNT_LH | 1 | 13 | 3-18584_GAS-SPRNG_50LB_CLOSED | 1 |
| 3 | 2-16504_HINGE_DOOR_WELDMENT | 2 | 14 | 3-19055_MSCR_M6X30_TH-TORX | 1 |
| 4 | 2-17130_HANDLE_LH_WELD | 1 | 15 | 3-19307_HANDLE_EXTERIO_INST | 1 |
| 5 | 3-10076_250_LOCK_WASHER | 1 | 16 | 3-19308_LATCH_DLP_615100-2_SW | 1 |
| 6 | 3-10084_250_WASHER | 1 | 17 | 3-19324_BUB_RUB_192_LG | 1 |
| 7 | 3-11821_BALL_STUD | 1 | 18 | 3-19325_FOAM_SPACER_DOOR | 2 |
| 8 | 3-15769_RUB-WASHER_371DX1250D | 4 | 19 | 3-19340_MSCR_313X75_TRUSS_TORX | 1 |
| 9 | 3-16217_GLASS_WASHER | 8 | 20 | 3-19342_MSCR_313X150_TRUSS_TORX | 4 |
| 10 | 3-16629_CABLE_TIE_STD_FLAT | 1 | 21 | 3-19614_LANYARD_312_X_1388 | 1 |
| 11 | 3-18453_MSCR_312-18X125_FH_TORX | 2 | 22 | 3-20329_NUT_NYLOC_FLNG_312 | 8 |
| | | | 23 | 3-20379_DOOR_GLASS | 1 |



REF MIRROR PART 4-16060

THIS DOCUMENT CONTAINS CONFIDENTIAL INFORMATION AND IS THE PROPERTY OF CUSTOM PRODUCTS OF LITCHFIELD, INC. AND MAY NOT BE COPIED, REPRODUCED OR DISCLOSED IN ANY MANNER WITHOUT EXPRESSED WRITTEN CONSENT FROM CUSTOM PRODUCTS OF LITCHFIELD, INC.

| | | |
|---|---|---------------------|
| TOLERANCES UNLESS NOTED OTHERWISE .X ± .09 .XX ± .06 .XXX ± .03 HOLE SIZE .05/-010 ANGLE ± 5° | CUSTOMER NAME & MOD NO.: JDX A-12099 MY14 | MATL SPEC: |
| CUSTOM PRODUCTS 1715 SOUTH SIBLEY AVE. LITCHFIELD, MN 55355 | | |
| TITLE DOOR ASSEMBLY, LH | DRWG SIZE C | DRWG NO. 4-16059 |
| | REV LEVEL C | DATE 09-30-13 |

NAME:CAD2 OBJECT:4-16060 DATE:25-Feb-14 08:03:27

| REV. | DCR NO. | DESCRIPTION | DRAFTSMAN | DATE |
|------|---------|--------------------------------|-----------|----------|
| A | - | GAS SPRING 3-18584 WAS 3-13024 | CAD | 10-18-13 |
| B | 11185 | ADDED LANYARD, NUT AND BOLT | CAD | 01-21-14 |
| C | 11236 | BOLT 3-19055 WAS 3-18312 | CAD | 02-25-14 |

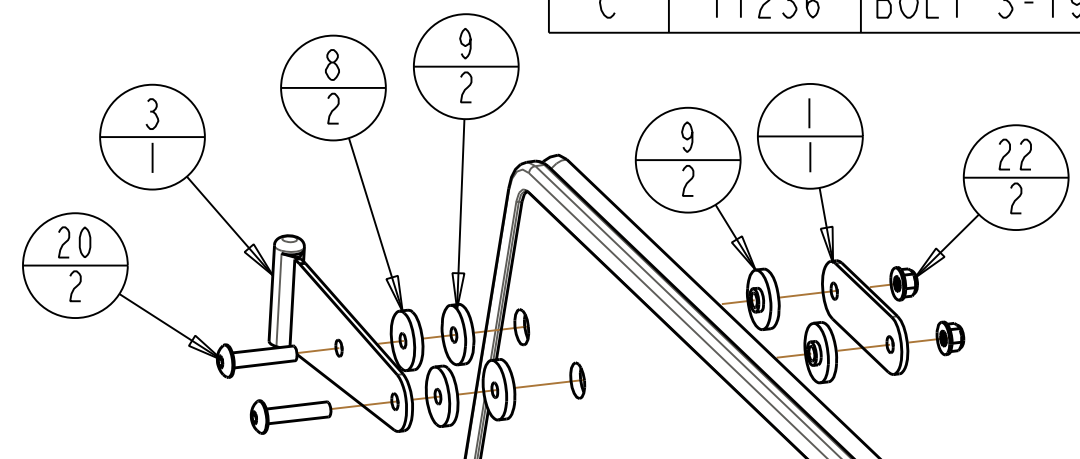
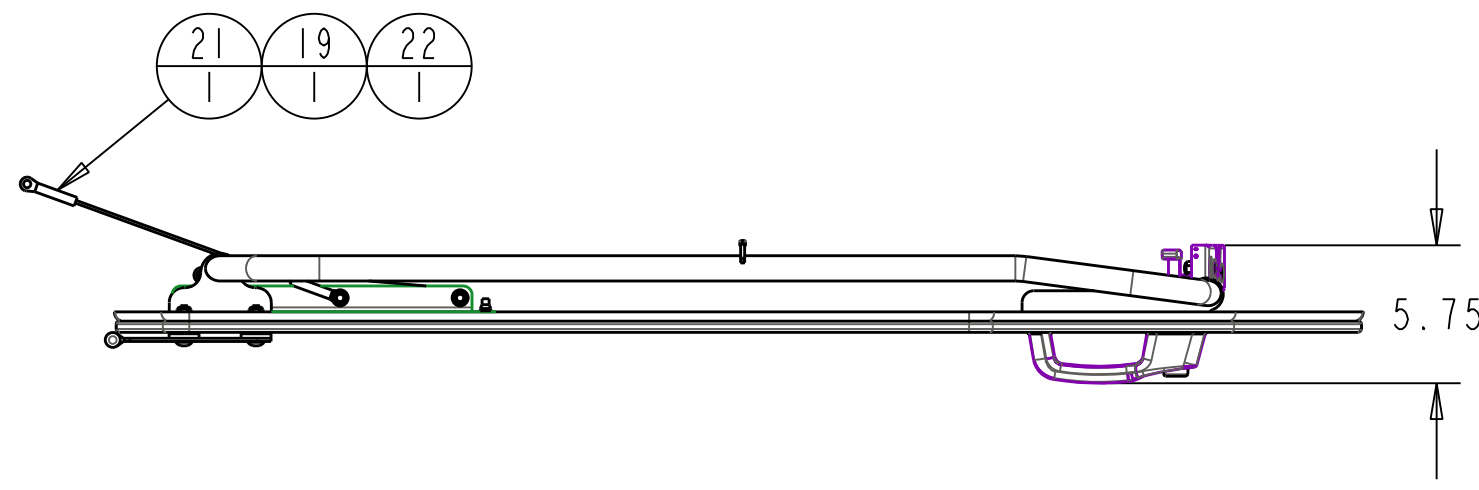

SCALE 0.250

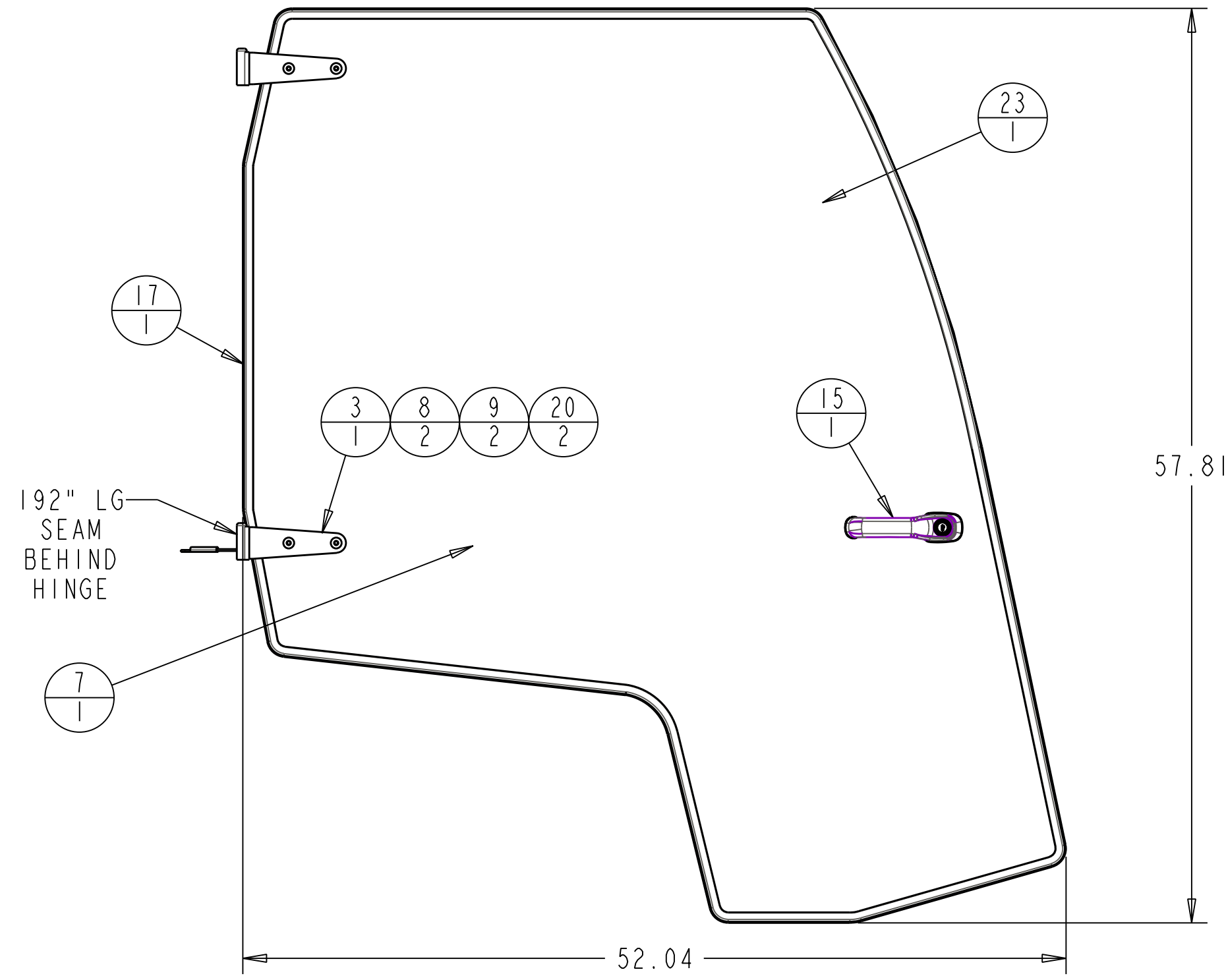

SCALE 0.125

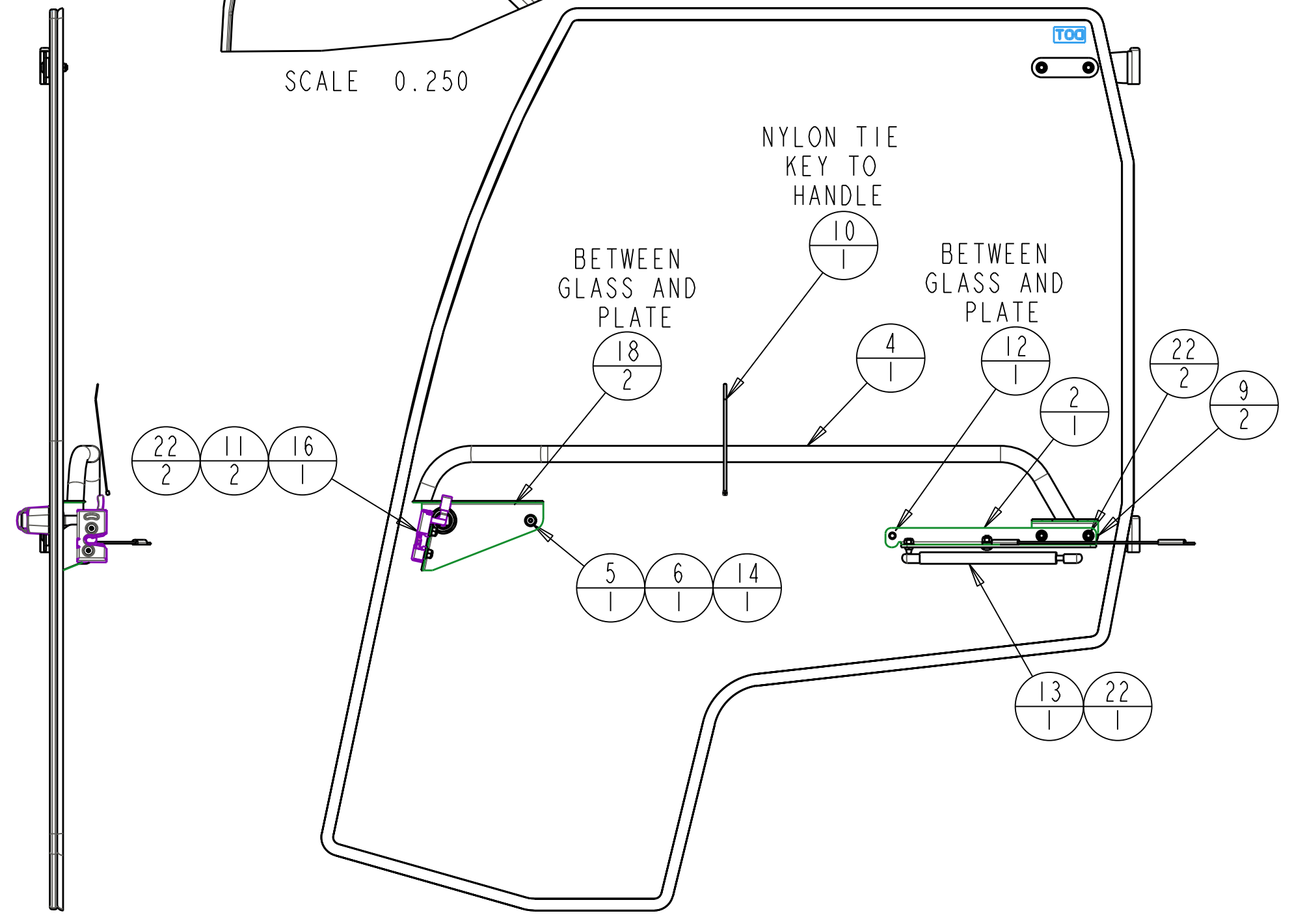

| ITEM # | DESCRIPTION | QTY | 12 | 13 | 14 | 15 | 16 | 17 | 18 | 19 | 20 | 21 | 22 | 23 |
|--------|---------------------------------|-----|-----------------------------|----|--------------------------------|----|---------------------------------|----|-----------------------------|----|-------------------------------|----|---------------------------|----|
| 1 | 1-48564_CAP_PLATE | 1 | 3-18480_RUB BUMPER_W_FLANGE | 1 | 3-18584_GAS-SPRNG_50LB_CLOSED | 1 | 3-19055_MSCR_M6X30_TH-TORX | 1 | 3-19307_HANDLE_EXTERIO_INST | 1 | 3-19309_LATCH_DLP_615100-1_SW | 1 | 3-19324_BUB_RUB_192_LG_MR | 1 |
| 2 | 1-49229_GS_MOUNT_RH_MIR | 1 | 3-19325_FOAM_SPACER_DOOR | 2 | 3-19340_MSCR_313X75_TRUSS_TORX | 1 | 3-19342_MSCR_313X150_TRUSS_TORX | 4 | 3-19614_LANYARD_312_X_1388 | 1 | 3-20329_NUT_NYLOC_FLNG_312 | 8 | 3-20379_DOOR_GLASS_MIR | 1 |
| 3 | 2-16504_HINGE_DOOR_WELDMENT | 2 | | | | | | | | | | | | |
| 4 | 2-17138_HANDLE_RH | 1 | | | | | | | | | | | | |
| 5 | 3-10076_250_LOCK_WASHER | 1 | | | | | | | | | | | | |
| 6 | 3-10084_250_WASHER | 1 | | | | | | | | | | | | |
| 7 | 3-11821_BALL_STUD | 1 | | | | | | | | | | | | |
| 8 | 3-15769_RUB-WASHER_371DX1250D | 4 | | | | | | | | | | | | |
| 9 | 3-16217_GLASS_WASHER | 8 | | | | | | | | | | | | |
| 10 | 3-16629_CABLE_TIE_STD_FLAT | 1 | | | | | | | | | | | | |
| 11 | 3-18453_MSCR_312-18X125_FH_TORX | 2 | | | | | | | | | | | | |

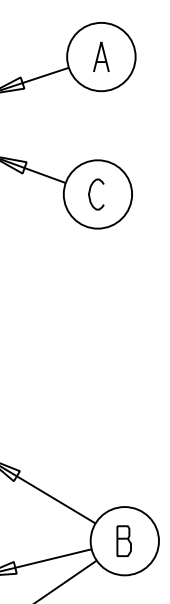

REF MIRROR PART 4-16059

THIS DOCUMENT CONTAINS CONFIDENTIAL INFORMATION AND IS THE PROPERTY OF CUSTOM PRODUCTS OF LITCHFIELD, INC. AND MAY NOT BE COPIED, REPRODUCED OR DISCLOSED IN ANY MANNER WITHOUT EXPRESSED WRITTEN CONSENT FROM CUSTOM PRODUCTS OF LITCHFIELD, INC.

| | | |
|--|---|------------|
| TOLERANCES UNLESS NOTED OTHERWISE | CUSTOMER NAME & MOD NO: JDX A-12099 MY14 | MATL SPEC: |
| .X ± .09 .XX ± .06 .XXX ± .03 HOLE SIZE .05/-010 ANGLE ± 5° | CUSTOM PRODUCTS 1715 SOUTH SIBLEY AVE. LITCHFIELD, MN 55355 | |
| TITLE | DRWG SIZE | DRWG NO. |
| DOOR ASSEMBLY, RH | C | 4-16060 |
| | REV LEVEL | |
| | C | |
| DRAWN: CAD | DATE: 09-30-13 | |